

# Lower Thames Crossing

## 2.4 Special Category Land Plans

### Volume B (Sheets 1 to 20)

#### (Clean version)

APFP Regulation 5(2)(i)(iv)

Infrastructure Planning (Applications:  
Prescribed Forms and Procedure)  
Regulations 2009

Volume 2

**DATE: December 2023**  
**DEADLINE: 9**

Planning Inspectorate Scheme Ref: TR010032  
Application Document Ref: TR010032/APP/2.4

**VERSION: 7.0**

### Revision history

Version	Date	Submitted at
1.0	31 October 2022	DCO Application
2.0	28 November 2022	Response to advice provided under section 51 of the Planning Act 2008 by the Planning Inspectorate
3.0	18 July 2023	Deadline 1
4.0	24 August 2023	Deadline 3
5.0	19 September 2023	Deadline 4
6.0	17 November 2023	Deadline 7
7.0	11 December 2023	Deadline 9

# Lower Thames Crossing

## 2.4 Special Category Land Plans

### Volume B (Sheets 1 to 20)

#### (Clean version)

#### List of contents

	<b>Page number</b>
<b>1 Introduction .....</b>	<b>1</b>
1.1 Purpose of this document .....	1
<b>2 Scope and format of the Special Category Land Plans .....</b>	<b>2</b>
<b>3 Schedule of Plans included in this application document .....</b>	<b>4</b>

# 1 Introduction

## 1.1 Purpose of this document

- 1.1.1 National Highways (the Applicant) has submitted an application under section 37 of the Planning Act 2008 for an order to grant development consent for the A122 Lower Thames Crossing (the Project)
- 1.1.2 This document is part of a suite of documents which accompanies the application to grant development consent. A full description of all the Application Documents is provided in the Introduction to the Application (Application Document 1.3) which also accompanies the application.
- 1.1.3 This document is included in the application to comply with Regulation 5(2)(i)(iv) and Regulation 5(4) of The Infrastructure Planning (Applications: Prescribed Forms and Procedures) Regulations 2009, which require:
- 5(2)(i) "a land plan identifying:...*
- (iv) where the land includes special category land and replacement land, that special category and replacement land".*
- 1.1.4 Regulation 5(4) requires that "Where a plan comprises three or more separate sheets a key plan must be provided showing the relationship between the different sheets".
- 1.1.5 Accordingly, a key plan is submitted as part of the application to identify the location of the Project in its wider geographical context.
- 1.1.6 This set of plans specifically identifies the special category land within the Order Limits, and any replacement land that will be secured under the provisions of the Order. The land within the Order Limits includes land that is common land and open space, these being types of land that fall within the definition of special category land. These plans identify those types of land, as well as whether it is proposed to permanently acquire land or rights or take temporary possession of such land.
- 1.1.7 In this plan set "the Order limits" means the limits of land to be acquired or used permanently or temporarily within which the authorised development may be carried out (see article 2 of the Order).



## 2 Scope and format of the Special Category Land Plans

- 2.1.1 To ensure sufficient detail and clarity of information, the Special Category Land Plans, sheets 1 to 49, have been prepared at a scale of 1:2,500. The key plan uses a smaller scale than that prescribed in Regulation 5(3) of the 2009 Regulations but only so that the Project can be represented in a single sheet plan.
- 2.1.2 The Applicant has adopted the same consistent approach for the Special Category Land Plans as has been used for the:
- a. Land Plans (Application Document 2.2),
  - b. the Crown Land Plans (Application Document 2.3),
  - c. the General Arrangement (Application Document 2.5),
  - d. the Works Plans (Application Document 2.6),
  - e. the Rights of Way and Access Plans (Application Document 2.7),
  - f. the Streets Subject to Temporary Restrictions of Use (Application Document 2.8),
  - g. the Traffic Regulation Measures (Application Document 2.10),
  - h. the Drainage Plans (Application Document 2.16).
- 2.1.3 The sheet layouts are the same for each of the aforementioned sets. This is intended to help interested parties understand the inter-relationship between the different sets of plans and to help illustrate the design of the Project more clearly.
- 2.1.4 Each plot of land shown on the Special Category Land Plans has been clearly delineated and given a unique reference, which corresponds with the referencing or plot numbering used in the Book of Reference (Application Document 4.2). The first number relates to the sheet on which the plot is located while the second number is used to distinguish between the plots.
- 2.1.5 In accordance with good practice, the plots have generally been numbered from west to east on each sheet following the sheet numbering system. The Order Limits are depicted on the Land Plans with a thicker red line to ensure that they are clearly distinguishable from the red lines used to depict plot boundaries.
- 2.1.6 This suite of plans is also closely linked to Part 5 of the Book of Reference (Application Document 4.2), which details the description of the special category land, and how it is affected.
- 2.1.7 Land shaded in pink with teal colour hatching indicates open space land that is to be permanently acquired.

- 2.1.8 Land shaded in green with teal colour hatching indicates open space land that is to be temporarily acquired.
- 2.1.9 Land shaded in blue with teal colour hatching indicates open space land that is to be used temporarily and over which rights are to be acquired.
- 2.1.10 Land shaded in pink with purple cross-hatching indicates common land that is to be permanently acquired.
- 2.1.11 Land shaded in green with purple cross-hatching indicates common land that is to be temporarily acquired.
- 2.1.12 Land shaded in blue with purple cross-hatching indicates common land that is to be used temporarily and over which rights are to be acquired.
- 2.1.13 Land shaded in grey indicates replacement land that is to be permanently acquired.
- 2.1.14 The Special Category Land Plans have been updated to reflect any Land Registry, Order Limit or land use changes. If these updates have resulted in a geometry change, the original plot number has been deleted and replaced with a new plot number or numbers.
- 2.1.15 These Land Plans have been updated for Deadline 4 to reflect any Land Registry and to include the proposed changes MRC01 and MRC03 following the procedural decision made by the Examining Authority [[PD-031](#)] resulting in Order Limits and land use update. If these updates have resulted in a geometry change, the original plot number has been deleted and replaced with a new plot number or numbers.
- 2.1.16 These Special Category Land Plans have been updated for Deadline 7 to include the proposed amendment EA07, as detailed in Deadline 5 cover letter [[REP5-001](#)], and proposed amendments EA08 and EA10, as explained in the Applicant's Amendment Letter (document number TR010032/EXAM/10.46). These plans also include the proposed change EC04 following the procedural decision made by the Examining Authority [[PD-045](#)], and reflect any Land Registry updates. If these updates have resulted in a geometry change, the original plot number has been deleted and replaced with a new plot number or numbers.
- 2.1.17 These Special Category Land Plans have been updated for Deadline 9 to include all agreed proposed changes and amendments throughout Examination.

### 3 Schedule of Plans included in this application document

Document Title	Document Number	Revision
SPECIAL CATEGORY LAND PLANS REGULATION 5(2)(i)(iv) KEY PLAN	TR010032/APP/2.4	P07
SPECIAL CATEGORY LAND PLANS REGULATION 5(2)(i)(iv) SHEET 1 OF 49	TR010032/APP/2.4	P07
SPECIAL CATEGORY LAND PLANS REGULATION 5(2)(i)(iv) SHEET 2 OF 49	TR010032/APP/2.4	P07
SPECIAL CATEGORY LAND PLANS REGULATION 5(2)(i)(iv) SHEET 3 OF 49	TR010032/APP/2.4	P07
SPECIAL CATEGORY LAND PLANS REGULATION 5(2)(i)(iv) SHEET 4 OF 49	TR010032/APP/2.4	P07
SPECIAL CATEGORY LAND PLANS REGULATION 5(2)(i)(iv) SHEET 5 OF 49	TR010032/APP/2.4	P07
SPECIAL CATEGORY LAND PLANS REGULATION 5(2)(i)(iv) SHEET 6 OF 49	TR010032/APP/2.4	P07
SPECIAL CATEGORY LAND PLANS REGULATION 5(2)(i)(iv) SHEET 7 OF 49	TR010032/APP/2.4	P07
SPECIAL CATEGORY LAND PLANS REGULATION 5(2)(i)(iv) SHEET 8 OF 49	TR010032/APP/2.4	P07
SPECIAL CATEGORY LAND PLANS REGULATION 5(2)(i)(iv) SHEET 9 OF 49	TR010032/APP/2.4	P07
SPECIAL CATEGORY LAND PLANS REGULATION 5(2)(i)(iv) SHEET 10 OF 49	TR010032/APP/2.4	P07
SPECIAL CATEGORY LAND PLANS REGULATION 5(2)(i)(iv) SHEET 11 OF 49	TR010032/APP/2.4	P07

Document Title	Document Number	Revision
SPECIAL CATEGORY LAND PLANS REGULATION 5(2)(i)(iv) SHEET 12 OF 49	TR010032/APP/2.4	P07
SPECIAL CATEGORY LAND PLANS REGULATION 5(2)(i)(iv) SHEET 13 OF 49	TR010032/APP/2.4	P07
SPECIAL CATEGORY LAND PLANS REGULATION 5(2)(i)(iv) SHEET 14 OF 49	TR010032/APP/2.4	P07
SPECIAL CATEGORY LAND PLANS REGULATION 5(2)(i)(iv) SHEET 15 OF 49	TR010032/APP/2.4	P07
SPECIAL CATEGORY LAND PLANS REGULATION 5(2)(i)(iv) SHEET 16 OF 49	TR010032/APP/2.4	P07
SPECIAL CATEGORY LAND PLANS REGULATION 5(2)(i)(iv) SHEET 17 OF 49	TR010032/APP/2.4	P07
SPECIAL CATEGORY LAND PLANS REGULATION 5(2)(i)(iv) SHEET 18 OF 49	TR010032/APP/2.4	P07
SPECIAL CATEGORY LAND PLANS REGULATION 5(2)(i)(iv) SHEET 19 OF 49	TR010032/APP/2.4	P07
SPECIAL CATEGORY LAND PLANS REGULATION 5(2)(i)(iv) SHEET 20 OF 49	TR010032/APP/2.4	P07
SPECIAL CATEGORY LAND PLANS REGULATION 5(2)(i)(iv) SHEET 21 OF 49	TR010032/APP/2.4	P07
SPECIAL CATEGORY LAND PLANS REGULATION 5(2)(i)(iv) SHEET 22 OF 49	TR010032/APP/2.4	P07
SPECIAL CATEGORY LAND PLANS REGULATION 5(2)(i)(iv) SHEET 23 OF 49	TR010032/APP/2.4	P07
SPECIAL CATEGORY LAND PLANS REGULATION 5(2)(i)(iv) SHEET 24 OF 49	TR010032/APP/2.4	P07

Document Title	Document Number	Revision
SPECIAL CATEGORY LAND PLANS REGULATION 5(2)(i)(iv) SHEET 25 OF 49	TR010032/APP/2.4	P07
SPECIAL CATEGORY LAND PLANS REGULATION 5(2)(i)(iv) SHEET 26 OF 49	TR010032/APP/2.4	P07
SPECIAL CATEGORY LAND PLANS REGULATION 5(2)(i)(iv) SHEET 27 OF 49	TR010032/APP/2.4	P07
SPECIAL CATEGORY LAND PLANS REGULATION 5(2)(i)(iv) SHEET 28 OF 49	TR010032/APP/2.4	P07
SPECIAL CATEGORY LAND PLANS REGULATION 5(2)(i)(iv) SHEET 29 OF 49	TR010032/APP/2.4	P07
SPECIAL CATEGORY LAND PLANS REGULATION 5(2)(i)(iv) SHEET 30 OF 49	TR010032/APP/2.4	P07
SPECIAL CATEGORY LAND PLANS REGULATION 5(2)(i)(iv) SHEET 31 OF 49	TR010032/APP/2.4	P07
SPECIAL CATEGORY LAND PLANS REGULATION 5(2)(i)(iv) SHEET 32 OF 49	TR010032/APP/2.4	P07
SPECIAL CATEGORY LAND PLANS REGULATION 5(2)(i)(iv) SHEET 33 OF 49	TR010032/APP/2.4	P07
SPECIAL CATEGORY LAND PLANS REGULATION 5(2)(i)(iv) SHEET 34 OF 49	TR010032/APP/2.4	P07
SPECIAL CATEGORY LAND PLANS REGULATION 5(2)(i)(iv) SHEET 35 OF 49	TR010032/APP/2.4	P07
SPECIAL CATEGORY LAND PLANS REGULATION 5(2)(i)(iv) SHEET 36 OF 49	TR010032/APP/2.4	P07
SPECIAL CATEGORY LAND PLANS REGULATION 5(2)(i)(iv) SHEET 37 OF 49	TR010032/APP/2.4	P07

Document Title	Document Number	Revision
SPECIAL CATEGORY LAND PLANS REGULATION 5(2)(i)(iv) SHEET 38 OF 49	TR010032/APP/2.4	P07
SPECIAL CATEGORY LAND PLANS REGULATION 5(2)(i)(iv) SHEET 39 OF 49	TR010032/APP/2.4	P07
SPECIAL CATEGORY LAND PLANS REGULATION 5(2)(i)(iv) SHEET 40 OF 49	TR010032/APP/2.4	P07
SPECIAL CATEGORY LAND PLANS REGULATION 5(2)(i)(iv) SHEET 41 OF 49	TR010032/APP/2.4	P07
SPECIAL CATEGORY LAND PLANS REGULATION 5(2)(i)(iv) SHEET 42 OF 49	TR010032/APP/2.4	P07
SPECIAL CATEGORY LAND PLANS REGULATION 5(2)(i)(iv) SHEET 43 OF 49	TR010032/APP/2.4	P07
SPECIAL CATEGORY LAND PLANS REGULATION 5(2)(i)(iv) SHEET 44 OF 49	TR010032/APP/2.4	P07
SPECIAL CATEGORY LAND PLANS REGULATION 5(2)(i)(iv) SHEET 45 OF 49	TR010032/APP/2.4	P07
SPECIAL CATEGORY LAND PLANS REGULATION 5(2)(i)(iv) SHEET 46 OF 49	TR010032/APP/2.4	P07
SPECIAL CATEGORY LAND PLANS REGULATION 5(2)(i)(iv) SHEET 47 OF 49	TR010032/APP/2.4	P07
SPECIAL CATEGORY LAND PLANS REGULATION 5(2)(i)(iv) SHEET 48 OF 49	TR010032/APP/2.4	P07
SPECIAL CATEGORY LAND PLANS REGULATION 5(2)(i)(iv) SHEET 49 OF 49	TR010032/APP/2.4	P07



M2

**NO DESIGN INFORMATION ON THIS SHEET  
FOR SPECIAL CATEGORY LAND PLANS**

Sheet 2  
Sheet 1

Tonbridge and  
Malling District  
Maidstone District

Westfield Wood

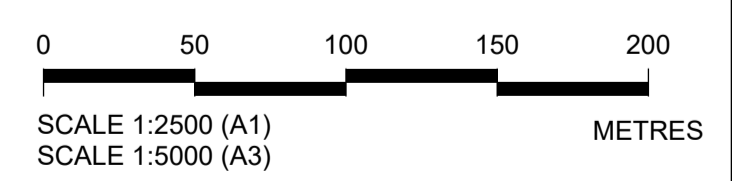

Rev	Status	Rev. Date	Purpose of revision	Drawn	Chck'd	Apprv'd
P07	S8	04/12/2023	Deadline 9	LS	CH	TG
P06	S8	06/11/2023	Deadline 7	LS	CH	TG
P05	S8	05/09/2023	Deadline 4	LS	CH	TG
P04	S8	03/08/2023	Deadline 3	LS	CH	TG
P03	S8	26/05/2023	Rule 6 Letter: Land Registry Update	LS	CH	TG
P02	S1	14/12/2022	Issued for Information	LS	AA	TG
P01	S1	03/10/2022	Issued for Information	LS	AA	TG

1. All dimensions are in metres unless stated otherwise.  
 2. These Special Category Land Plans should be read in conjunction with other plans and documents in the Development Consent Order application (TR020032/APP/3.1), in particular the Book of Reference (TR020032/APP/4.2).  
 3. All easements, servitudes and private rights in land are proposed to be extinguished on land shown coloured pink on these land plans, unless stated otherwise in the Book of Reference.  
 4. All easements, servitudes and private rights in land are proposed to be extinguished, so far as their continued exercise would be inconsistent with the exercise of the rights or restrictions proposed to be acquired by the undertaker on land shown coloured blue on these land plans, unless stated otherwise in the Book of Reference.  
 5. All easements, servitudes and private rights are proposed to be suspended while the undertaker is in temporary possession of the land shown coloured green and blue on these land plans, unless stated otherwise in the Book of Reference.  
 6. The number labels relate to plot numbers. Please refer to the Book of Reference for more information about these plots, including the approximate area of each plot. In this numbering convention, a plot number comprises the sheet number followed by the actual plot number, e.g. Plot 01-24, where '01' is the sheet number.  
 7. Some plots have two leader lines to the same label. These are the same plot connected by a small area that could not be displayed at a suitable scale.

**Legend**  
 Order Limits  
 Local Authority Boundary

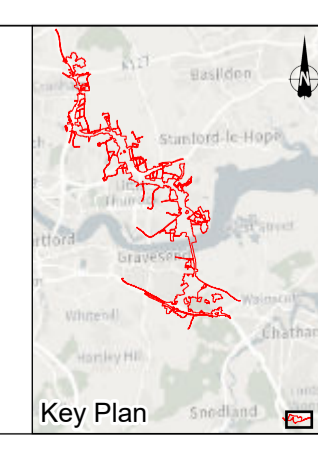

Client  
 national highways  
 Project  
 LOWER THAMES CROSSING

Status	DCO Application	Original Size	A1	Revision	P07
Application Document Number	TR010032/APP/2.4	Scale	1:2,500		
Drawing Title	SPECIAL CATEGORY LAND PLANS REGULATION 5(2)(i)(iv) SHEET 1				
Drawing Number	HE540039-CJV-BOP-ZZZ_BD000000_-DR-BL-40001				



**NO DESIGN INFORMATION ON THIS SHEET  
FOR SPECIAL CATEGORY LAND PLANS**

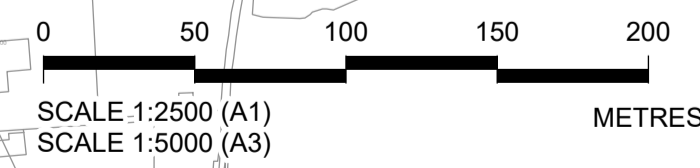

P07	S8	04/12/2023	Deadline 9	LS	CH	TG
P06	S8	06/11/2023	Deadline 7	LS	CH	TG
P05	S8	05/09/2023	Deadline 4	LS	CH	TG
P04	S8	03/08/2023	Deadline 3	LS	CH	TG
P03	S8	26/05/2023	Rule 6 Letter: Land Registry Update	LS	CH	TG
P02	S1	14/12/2022	Issued for Information	LS	AA	TG
P01	S1	03/10/2022	Issued for Information	LS	AA	TG
Rev	Status	Rev. Date	Purpose of revision	Drawn	Chck'd	Apprv'd

1. All dimensions are in metres unless stated otherwise.  
 2. These Special Category Land Plans should be read in conjunction with other plans and documents in the Development Consent Order application (TR020032/APP/3.1), in particular the Book of Reference (TR020032/APP/4.2).  
 3. All easements, servitudes and private rights in land are proposed to be extinguished on land shown coloured pink on these land plans, unless stated otherwise in the Book of Reference.  
 4. All easements, servitudes and private rights in land are proposed to be extinguished, so far as their continued exercise would be inconsistent with the exercise of the rights or restrictions proposed to be acquired by the undertaker on land shown coloured blue on these land plans, unless stated otherwise in the Book of Reference.  
 5. All easements, servitudes and private rights are proposed to be suspended while the undertaker is in temporary possession of the land shown coloured green and blue on these land plans, unless stated otherwise in the Book of Reference.  
 6. The number labels relate to plot numbers. Please refer to the Book of Reference for more information about these plots, including the approximate area of each plot. In this numbering convention, a plot number comprises the sheet number followed by the actual plot number, e.g. Plot 01-24, where '01' is the sheet number.  
 7. Some plots have two leader lines to the same label. These are the same plot connected by a small area that could not be displayed at a suitable scale.

**Legend**  
 Order Limits

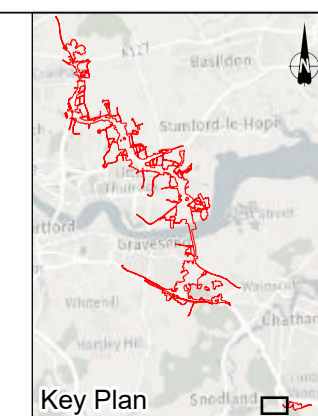

Client  
  
 Project  
**LOWER THAMES CROSSING**

Status	DCO Application	Original Size	A1	Revision	P07
Application Document Number	TR010032/APP/2.4	Scale	1:2,500		
Drawing Title	<b>SPECIAL CATEGORY LAND PLANS REGULATION 5(2)(i)(iv) SHEET 2</b>				
Drawing Number	HE540039-CJV-BOP-ZZZ_BD000000_-DR-BL-40002				

Sheet 2  
Sheet 1



Sheet 10  
Sheet 3

Sheet 9  
Sheet 3



Local Authority:  
Gravesham Borough Council

A289

Great Crabbles  
Wood SSSI

Great Crabbles Wood

Kent Downs  
AONB

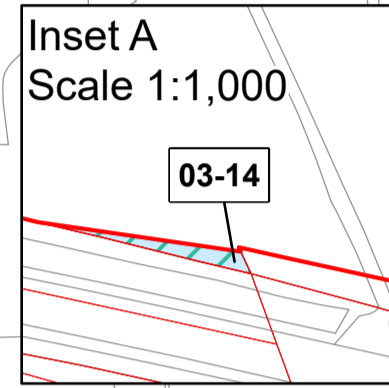

03-14

Brewers  
Wood

Inset A

03-43

03-54

03-85

Sheet 4  
Sheet 3

Gravesham  
Borough Council  
Medway Council

HS1

Cole Wood

M2

Kent Downs  
AONB

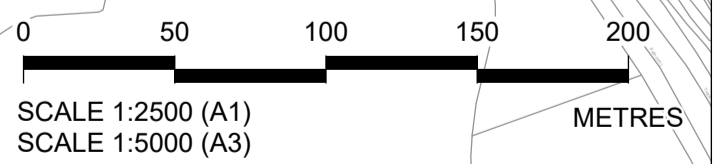

Crown copyright material is reproduced with the permission of Land Registry under delegated authority from the Controller of HMSO. This material was last updated in October 2023 and may not be copied, distributed, sold or published without the formal permission of Land Registry. Contains Ordnance Survey data. © Crown copyright and database rights 2023. OS ACN000827444.						
P07	S8	04/12/2023	Deadline 9	LS	CH	TG
P06	S8	06/11/2023	Deadline 7	LS	CH	TG
P05	S8	05/09/2023	Deadline 4	LS	CH	TG
P04	S8	03/08/2023	Deadline 3	LS	CH	TG
P03	S8	26/05/2023	Rule 6 Letter: Land Registry Update	LS	CH	TG
P02	S1	14/12/2022	Issued for Information	LS	AA	TG
P01	S1	03/10/2022	Issued for Information	LS	AA	TG
Rev	Status	Rev. Date	Purpose of revision	Drawn	Chck'd	Apprv'd

1. All dimensions are in metres unless stated otherwise.  
 2. These Special Category Land Plans should be read in conjunction with other plans and documents in the Development Consent Order application (TR020032/APP/3.1), in particular the Book of Reference (TR020032/APP/4.2).  
 3. All easements, servitudes and private rights in land are proposed to be extinguished on land shown coloured pink on these land plans, unless stated otherwise in the Book of Reference.  
 4. All easements, servitudes and private rights in land are proposed to be extinguished, so far as their continued exercise would be inconsistent with the exercise of the rights or restrictions proposed to be acquired by the undertaker on land shown coloured blue on these land plans, unless stated otherwise in the Book of Reference.  
 5. All easements, servitudes and private rights are proposed to be suspended while the undertaker is in temporary possession of the land shown coloured green and blue on these land plans, unless stated otherwise in the Book of Reference.  
 6. The number labels relate to plot numbers. Please refer to the Book of Reference for more information about these plots, including the approximate area of each plot. In this numbering convention, a plot number comprises the sheet number followed by the actual plot number, e.g. Plot 01-24, where '01' is the sheet number.  
 7. Some plots have two leader lines to the same label. These are the same plot connected by a small area that could not be displayed at a suitable scale.

**Legend**

- Order Limits
- Open Space - Temporary Possession of Land and Permanent Acquisition of Rights
- Replacement Land
- Local Authority Boundary

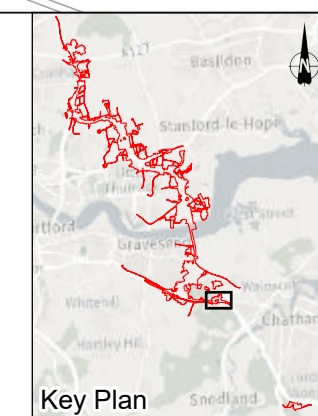

Client:

Project: **LOWER THAMES CROSSING**

Status	DCO Application	Original Size	A1	Revision	P07
Application Document Number	TR010032/APP/2.4	Scale	1:2,500		
Drawing Title	<b>SPECIAL CATEGORY LAND PLANS REGULATION 5(2)(i)(iv) SHEET 3</b>				
Drawing Number	HE540039-CJV-BOP-ZZZ_BD000000_-DR-BL-40003				



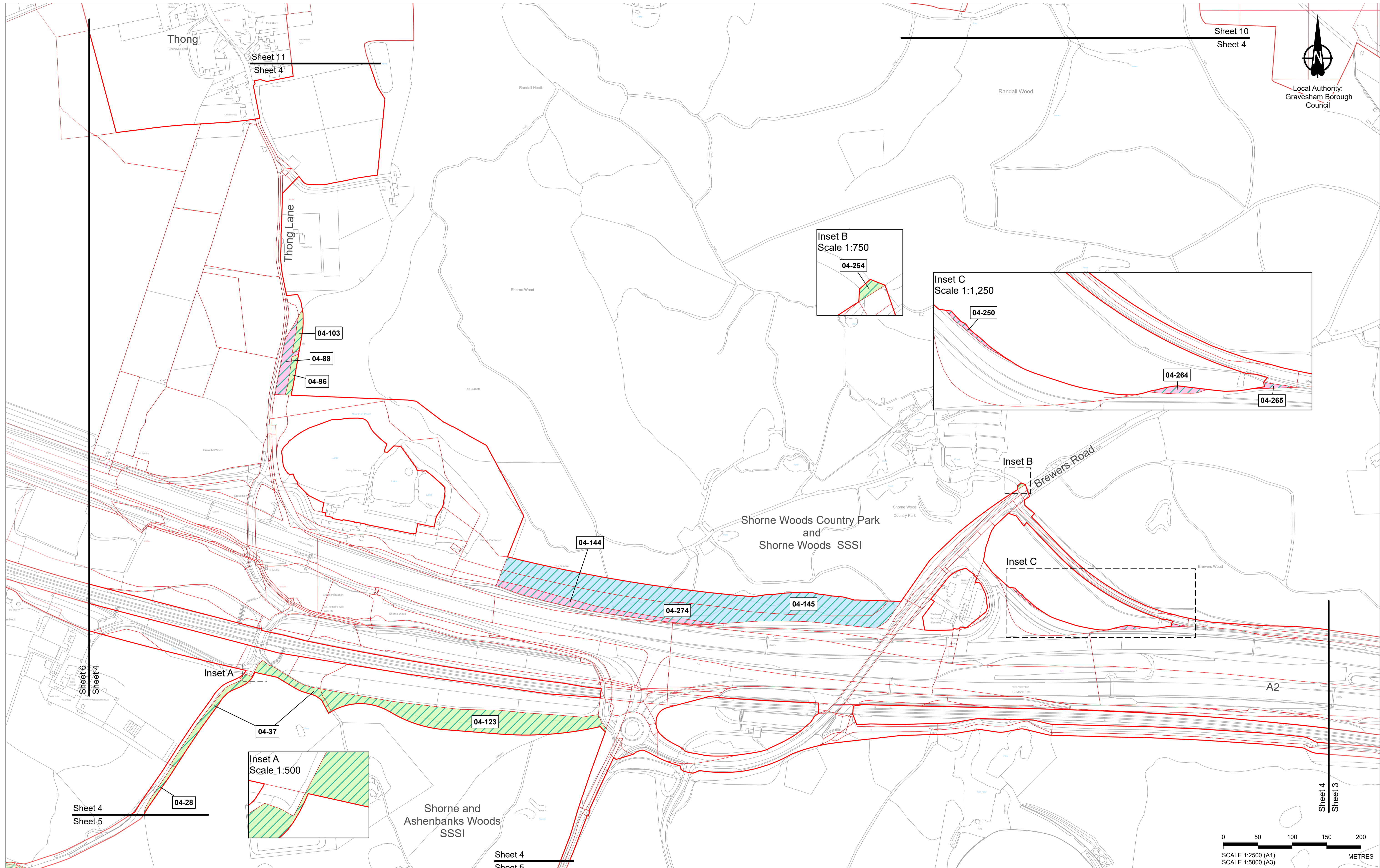

Sheet 10  
Sheet 4

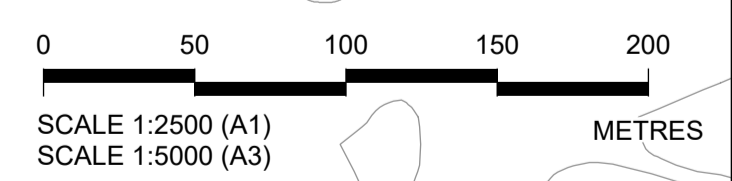
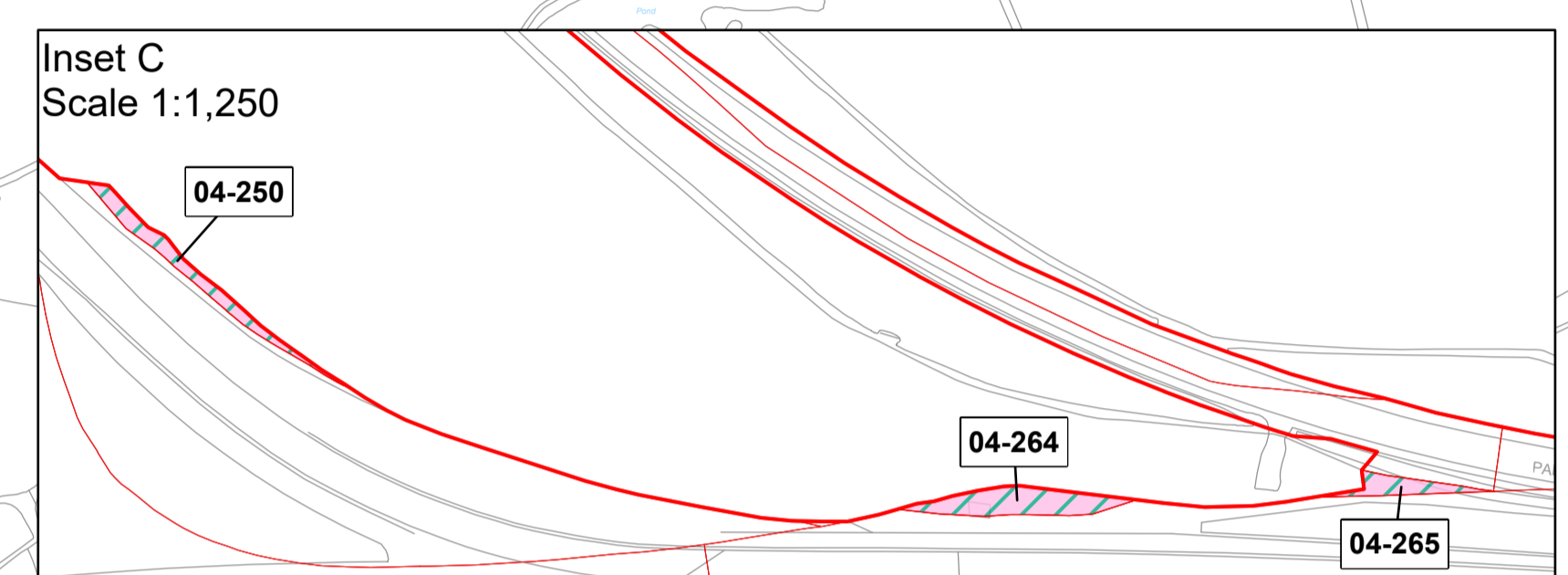
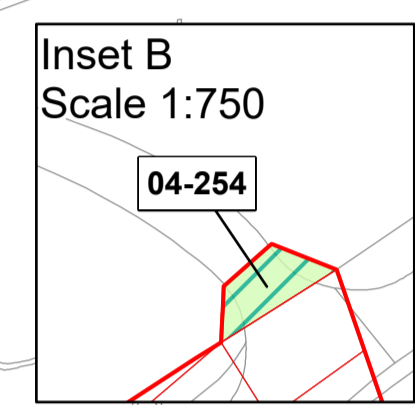

Crown copyright material is reproduced with the permission of Land Registry under delegated authority from the Controller of HMSO. This material was last updated in October 2023 and may not be copied, distributed, sold or published without the formal permission of Land Registry. Contains Ordnance Survey data. © Crown copyright and database rights 2023. OS A201000827444.

Rev	Status	Rev. Date	Purpose of revision	Drawn	Chck'd	Apprv'd
P07	S8	04/12/2023	Deadline 9	LS	CH	TG
P06	S8	06/11/2023	Deadline 7	LS	CH	TG
P05	S8	05/09/2023	Deadline 4	LS	CH	TG
P04	S8	03/08/2023	Deadline 3	LS	CH	TG
P03	S8	26/05/2023	Rule 6 Letter: Land Registry Update	LS	CH	TG
P02	S1	14/12/2022	Issued for Information	LS	AA	TG
P01	S1	03/10/2022	Issued for Information	LS	AA	TG

- All dimensions are in metres unless stated otherwise.
- These Special Category Land Plans should be read in conjunction with other plans and documents in the Development Consent Order application (TR020032/APP/3.1), in particular the Book of Reference (TR020032/APP/4.2).
- All easements, servitudes and private rights in land are proposed to be extinguished on land shown coloured pink on these land plans, unless stated otherwise in the Book of Reference.
- All easements, servitudes and private rights in land are proposed to be extinguished, so far as their continued exercise would be inconsistent with the exercise of the rights or restrictions proposed to be acquired by the undertaker on land shown coloured blue on these land plans, unless stated otherwise in the Book of Reference.
- All easements, servitudes and private rights are proposed to be suspended while the undertaker is in temporary possession of the land shown coloured green and blue on these land plans, unless stated otherwise in the Book of Reference.
- The number labels relate to plot numbers. Please refer to the Book of Reference for more information about these plots, including the approximate area of each plot. In this numbering convention, a plot number comprises the sheet number followed by the actual plot number, e.g. Plot 01-24, where '01' is the sheet number.
- Some plots have two leader lines to the same label. These are the same plot connected by a small area that could not be displayed at a suitable scale e.g. Plot 04-37 on this sheet

- Legend**
- Order Limits
  - Open Space - Permanent Acquisition of Land
  - Open Space - Temporary Possession of Land
  - Open Space - Temporary Possession of Land and Permanent Acquisition of Rights

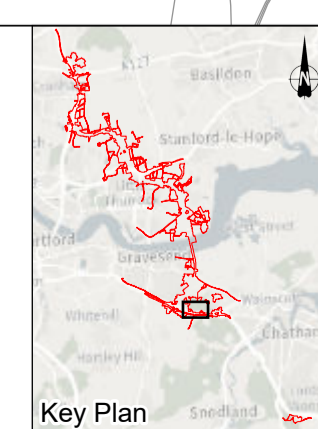

Client  
**national highways**

Project  
**LOWER THAMES CROSSING**

Status	DCO Application	Original Size	A1	Revision	P07
Application Document Number	TR010032/APP/2.4	Scale	1:2,500		
Drawing Title	<b>SPECIAL CATEGORY LAND PLANS REGULATION 5(2)(i)(iv) SHEET 4</b>				
Drawing Number	HE540039-CJV-BOP-ZZZ_BD000000_-DR-BL-40004				



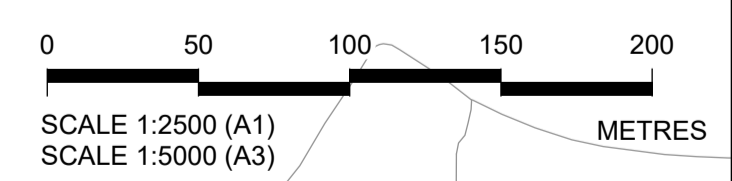
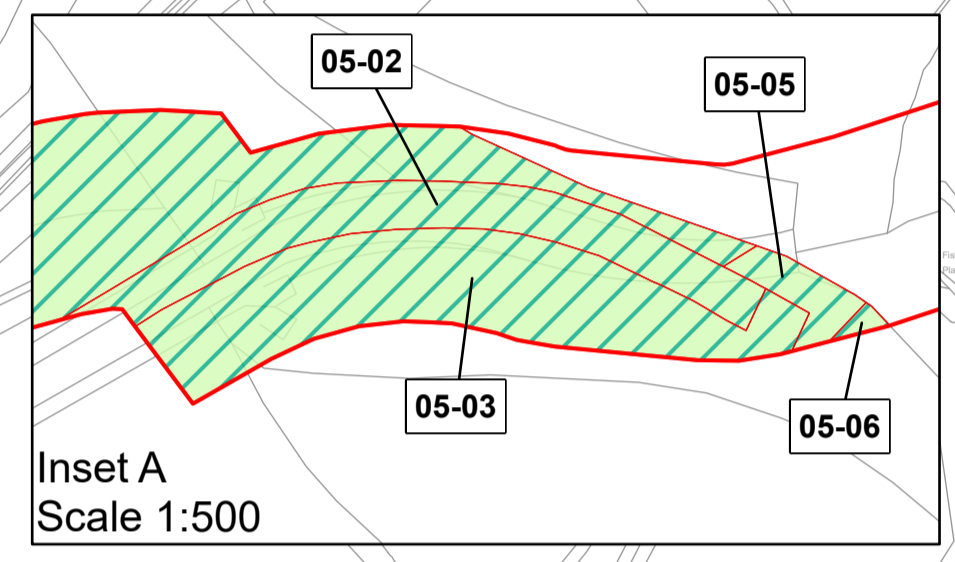
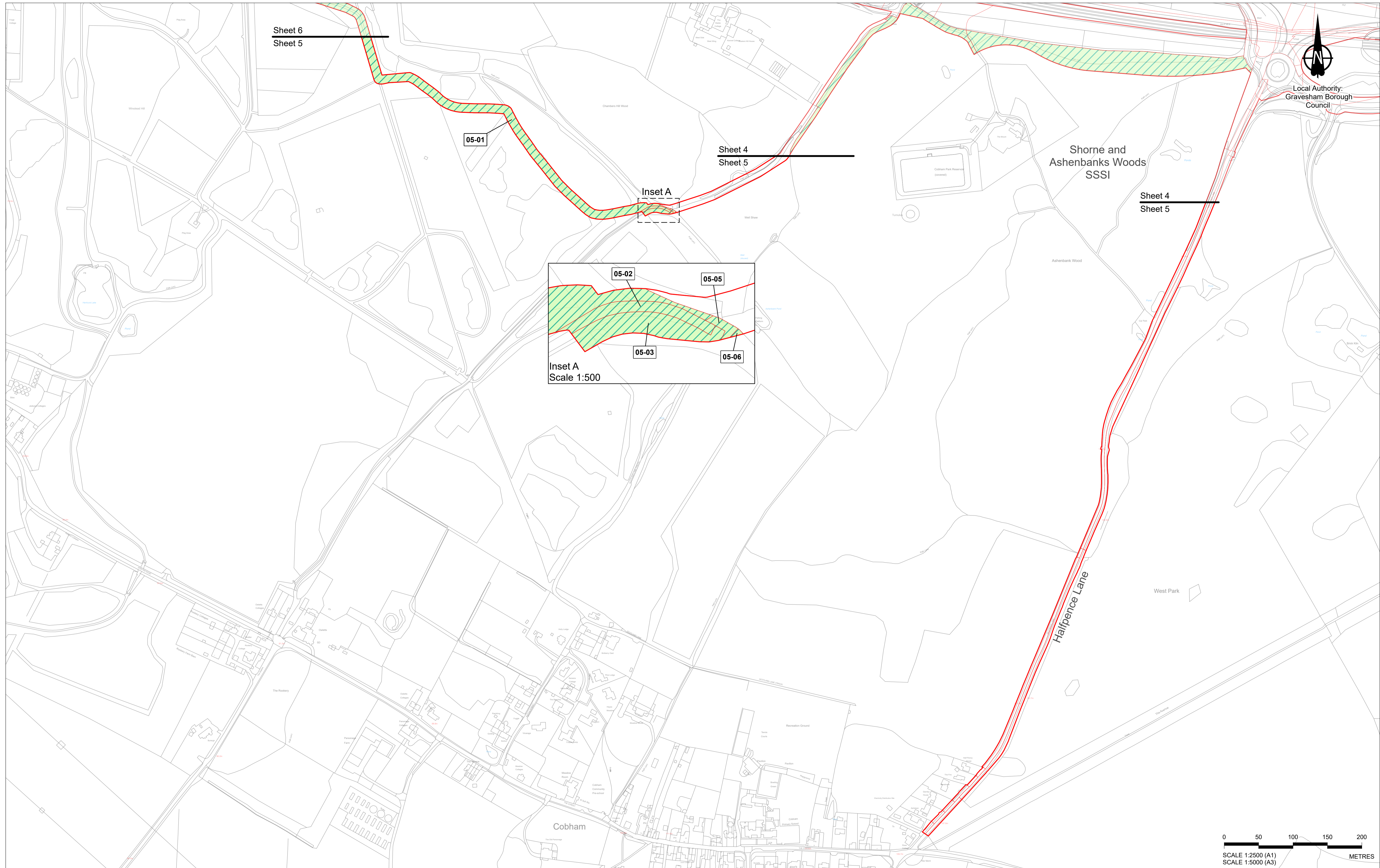

Crown copyright material is reproduced with the permission of Land Registry under delegated authority from the Controller of HMSO. This material was last updated in October 2023 and may not be copied, distributed, sold or published without the formal permission of Land Registry. Contains Ordnance Survey data. © Crown copyright and database rights 2023. OS AC20000827444.

Rev	Status	Rev. Date	Purpose of revision	Drawn	Chck'd	Apprv'd
P07	S8	04/12/2023	Deadline 9	LS	CH	TG
P06	S8	06/11/2023	Deadline 7	LS	CH	TG
P05	S8	05/09/2023	Deadline 4	LS	CH	TG
P04	S8	03/08/2023	Deadline 3	LS	CH	TG
P03	S8	26/05/2023	Rule 6 Letter: Land Registry Update	LS	CH	TG
P02	S1	14/12/2022	Issued for Information	LS	AA	TG
P01	S1	03/10/2022	Issued for Information	LS	AA	TG

- All dimensions are in metres unless stated otherwise.
- These Special Category Land Plans should be read in conjunction with other plans and documents in the Development Consent Order application (TR020032/APP/3.1), in particular the Book of Reference (TR020032/APP/4.2).
- All easements, servitudes and private rights in land are proposed to be extinguished on land shown coloured pink on these land plans, unless stated otherwise in the Book of Reference.
- All easements, servitudes and private rights in land are proposed to be extinguished, so far as their continued exercise would be inconsistent with the exercise of the rights or restrictions proposed to be acquired by the undertaker on land shown coloured blue on these land plans, unless stated otherwise in the Book of Reference.
- All easements, servitudes and private rights are proposed to be suspended while the undertaker is in temporary possession of the land shown coloured green and blue on these land plans, unless stated otherwise in the Book of Reference.
- The number labels relate to plot numbers. Please refer to the Book of Reference for more information about these plots, including the approximate area of each plot. In this numbering convention, a plot number comprises the sheet number followed by the actual plot number, e.g. Plot 01-24, where '01' is the sheet number.
- Some plots have two leader lines to the same label. These are the same plot connected by a small area that could not be displayed at a suitable scale.

**Legend**  
 Order Limits  
 Open Space - Temporary Possession of Land

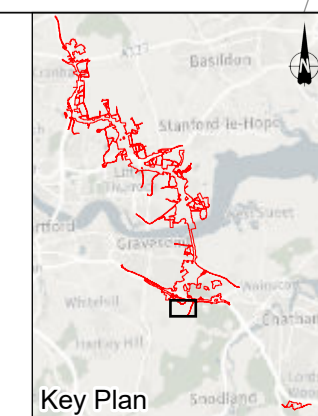

Client  
  
 Project  
**LOWER THAMES CROSSING**

Status	DCO Application	Original Size	A1	Revision	P07
Application Document Number	TR010032/APP/2.4	Scale	1:2,500		
Drawing Title	<b>SPECIAL CATEGORY LAND PLANS REGULATION 5(2)(i)(iv) SHEET 5</b>				
Drawing Number	HE540039-CJV-BOP-ZZZ_BD000000_-DR-BL-40005				



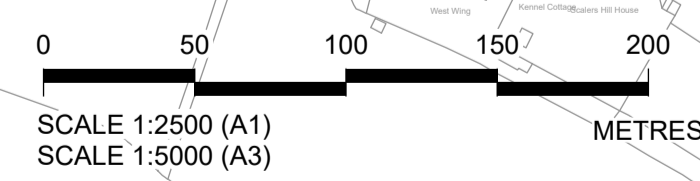
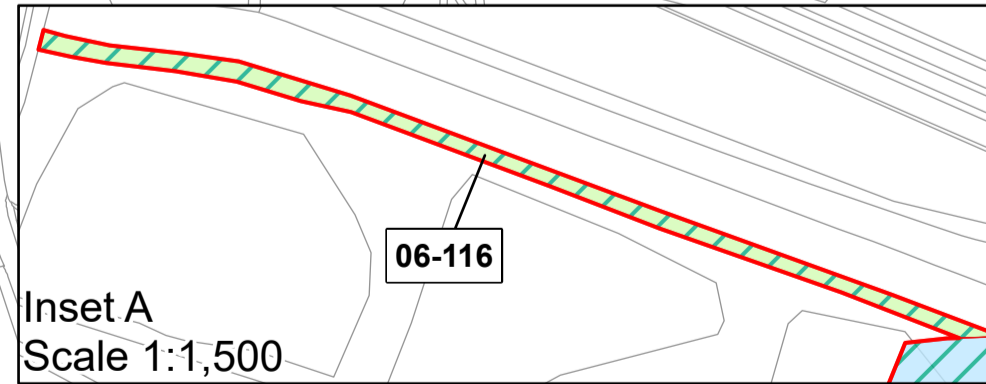
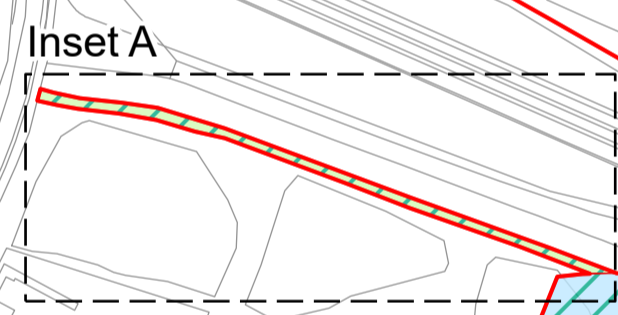
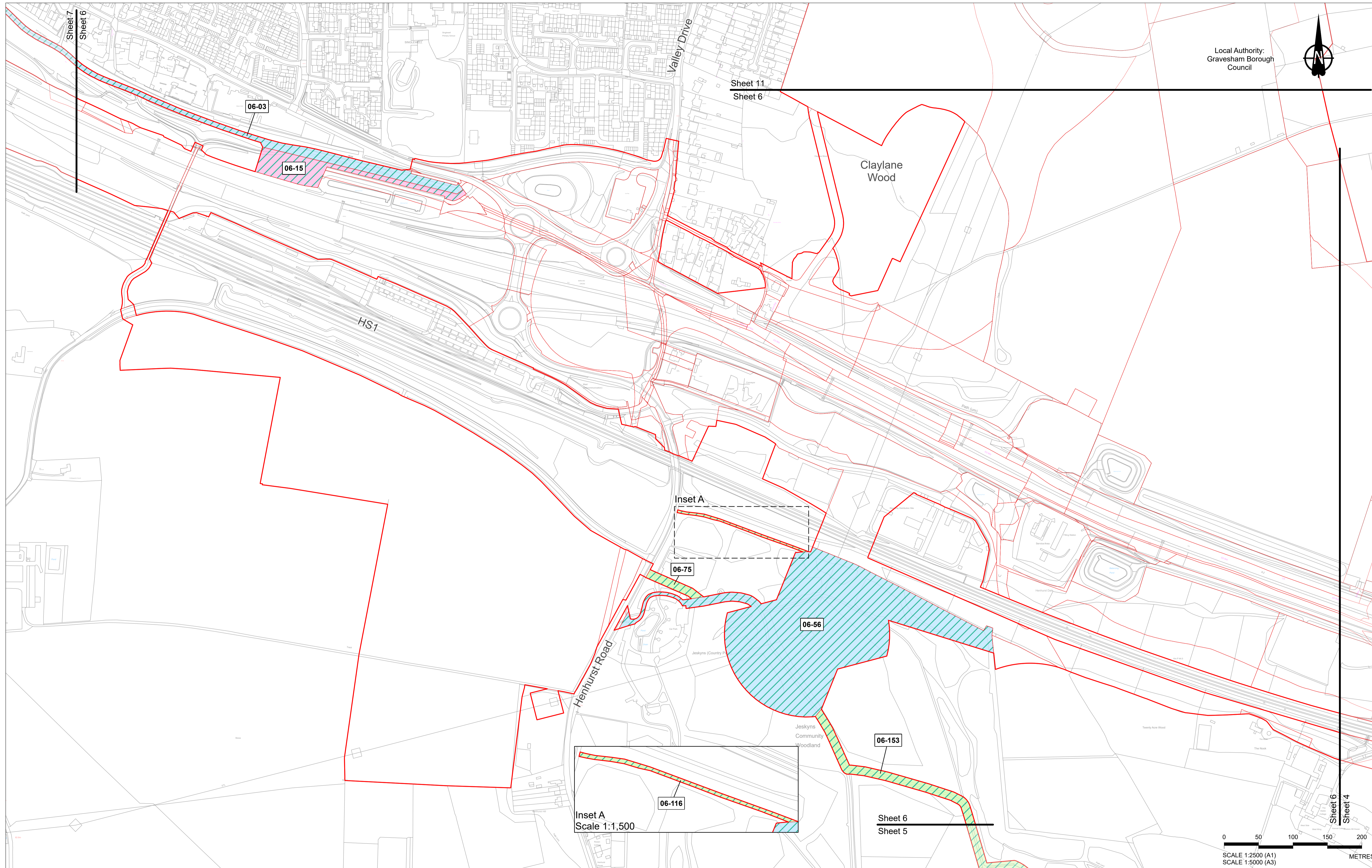

Crown copyright material is reproduced with the permission of Land Registry under delegated authority from the Controller of HMSO. This material was last updated in October 2023 and may not be copied, distributed, sold or published without the formal permission of Land Registry. Contains Ordnance Survey data. © Crown copyright and database rights 2023. OS ACN000827444.

Rev	Status	Rev. Date	Purpose for revision	Drawn	Chck'd	Apprv'd
P07	S8	04/12/2023	Deadline 9	LS	CH	TG
P06	S8	06/11/2023	Deadline 7	LS	CH	TG
P05	S8	05/09/2023	Deadline 4	LS	CH	TG
P04	S8	03/08/2023	Deadline 3	LS	CH	TG
P03	S8	26/05/2023	Rule 6 Letter: Land Registry Update	LS	CH	TG
P02	S1	14/12/2022	Issued for Information	LS	AA	TG
P01	S1	03/10/2022	Issued for Information	LS	AA	TG

- All dimensions are in metres unless stated otherwise.
- These Special Category Land Plans should be read in conjunction with other plans and documents in the Development Consent Order application (TR020032/APP/3.1), in particular the Book of Reference (TR020032/APP/4.2).
- All easements, servitudes and private rights in land are proposed to be extinguished on land shown coloured pink on these land plans, unless stated otherwise in the Book of Reference.
- All easements, servitudes and private rights in land are proposed to be extinguished, so far as their continued exercise would be inconsistent with the exercise of the rights or restrictions proposed to be acquired by the undertaker on land shown coloured blue on these land plans, unless stated otherwise in the Book of Reference.
- All easements, servitudes and private rights are proposed to be suspended while the undertaker is in temporary possession of the land shown coloured green and blue on these land plans, unless stated otherwise in the Book of Reference.
- The number labels relate to plot numbers. Please refer to the Book of Reference for more information about these plots, including the approximate area of each plot. In this numbering convention, a plot number comprises the sheet number followed by the actual plot number, e.g. Plot 01-24, where '01' is the sheet number.
- Some plots have two leader lines to the same label. These are the same plot connected by a small area that could not be displayed at a suitable scale.

- Legend**
- Order Limits
  - Open Space - Permanent Acquisition of Land
  - Open Space - Temporary Possession of Land
  - Open Space - Temporary Possession of Land and Permanent Acquisition of Rights

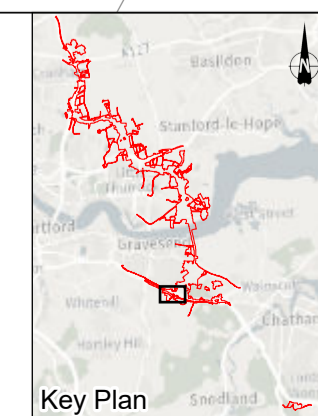

Client  
**national highways**

Project  
**LOWER THAMES CROSSING**

Status	DCO Application	Original Size	A1	Revision	P07
Application Document Number	TR010032/APP/2.4	Scale	1:2,500		
Drawing Title	<b>SPECIAL CATEGORY LAND PLANS REGULATION 5(2)(i)(iv) SHEET 6</b>				
Drawing Number	HE540039-CJV-BOP-ZZZ_BD000000_-DR-BL-40006				



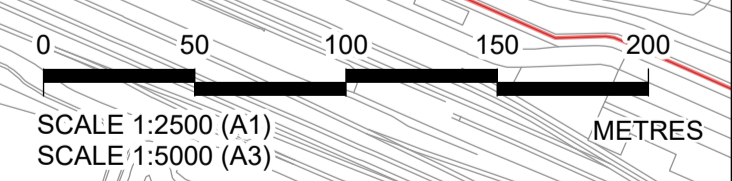
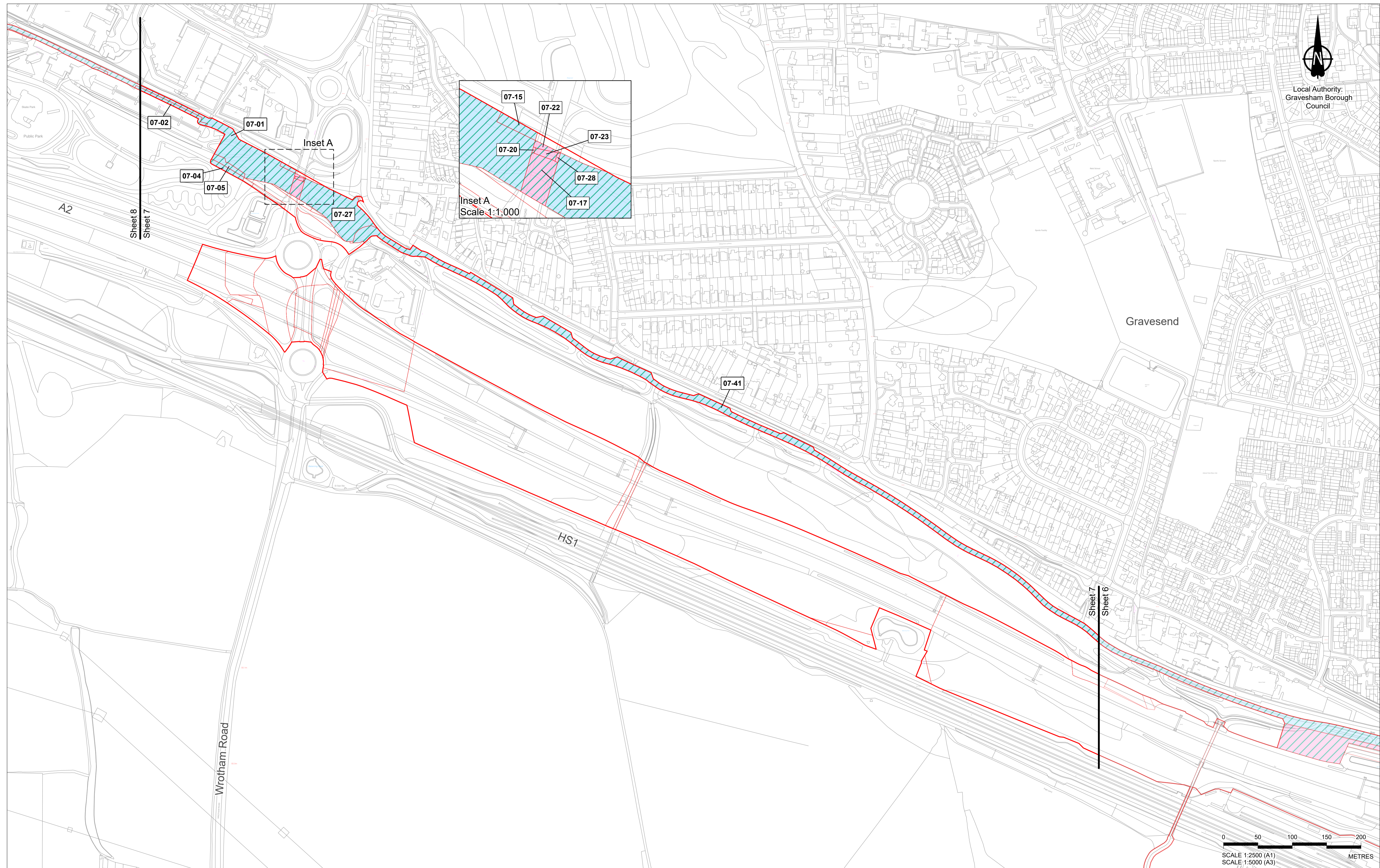

Crown copyright material is reproduced with the permission of Land Registry under delegated authority from the Controller of HMSO. This material was last updated in October 2023 and may not be copied, distributed, sold or published without the formal permission of Land Registry. Contains Ordnance Survey data. © Crown copyright and database rights 2023. OS A20000827444.

Rev	Status	Rev. Date	Purpose of revision	Drawn	Chck'd	Apprv'd
P07	S8	04/12/2023	Deadline 9	LS	CH	TG
P06	S8	06/11/2023	Deadline 7	LS	CH	TG
P05	S8	05/09/2023	Deadline 4	LS	CH	TG
P04	S8	03/08/2023	Deadline 3	LS	CH	TG
P03	S8	26/05/2023	Rule 6 Letter: Land Registry Update	LS	CH	TG
P02	S1	14/12/2022	Issued for Information	LS	AA	TG
P01	S1	03/10/2022	Issued for Information	LS	AA	TG

- All dimensions are in metres unless stated otherwise.
- These Special Category Land Plans should be read in conjunction with other plans and documents in the Development Consent Order application (TR020032/APP/3.1), in particular the Book of Reference (TR020032/APP/4.2).
- All easements, servitudes and private rights in land are proposed to be extinguished on land shown coloured pink on these land plans, unless stated otherwise in the Book of Reference.
- All easements, servitudes and private rights in land are proposed to be extinguished, so far as their continued exercise would be inconsistent with the exercise of the rights or restrictions proposed to be acquired by the undertaker on land shown coloured blue on these land plans, unless stated otherwise in the Book of Reference.
- All easements, servitudes and private rights are proposed to be suspended while the undertaker is in temporary possession of the land shown coloured green and blue on these land plans, unless stated otherwise in the Book of Reference.
- The number labels relate to plot numbers. Please refer to the Book of Reference for more information about these plots, including the approximate area of each plot. In this numbering convention, a plot number comprises the sheet number followed by the actual plot number, e.g. Plot 01-24, where '01' is the sheet number.
- Some plots have two leader lines to the same label. These are the same plot connected by a small area that could not be displayed at a suitable scale.

- Legend**
- Order Limits
  - Open Space - Permanent Acquisition of Land
  - Open Space - Temporary Possession of Land and Permanent Acquisition of Rights

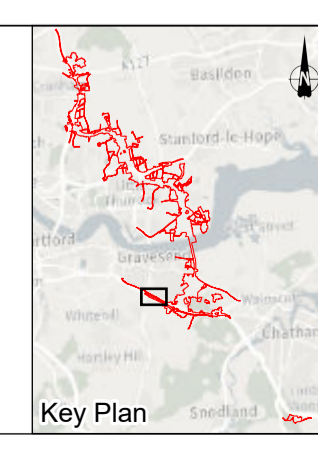

Client  
**national highways**

Project  
**LOWER THAMES CROSSING**

Status	DCO Application	Original Size	A1	Revision	P07
Application Document Number	TR010032/APP/2.4	Scale	1:2,500		
Drawing Title	<b>SPECIAL CATEGORY LAND PLANS REGULATION 5(2)(i)(iv) SHEET 7</b>				
Drawing Number	HE540039-CJV-BOP-ZZZ_BD000000_-DR-BL-40007				



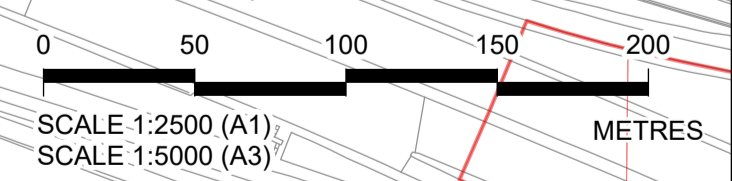
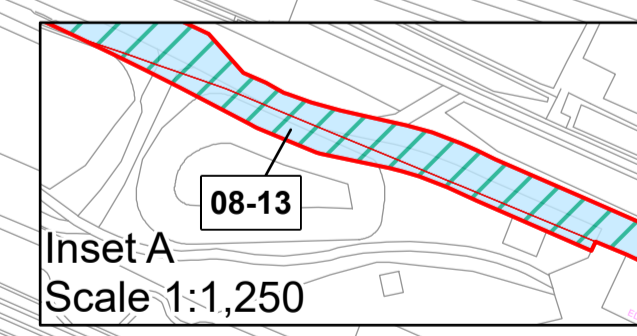
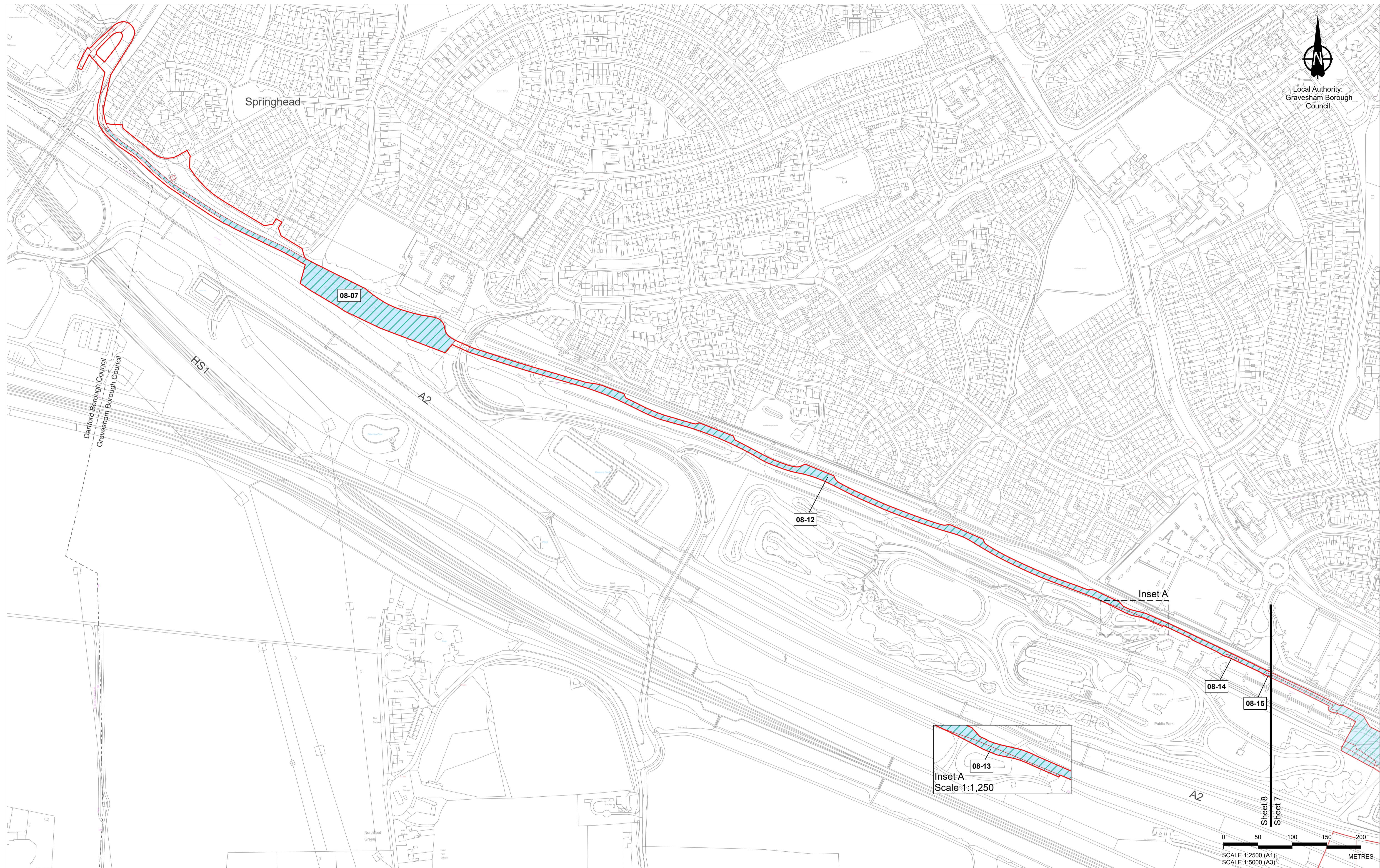

Rev	Status	Rev. Date	Purpose of revision	Drawn	Chck'd	Apprv'd
P07	S8	04/12/2023	Deadline 9	LS	CH	TG
P06	S8	06/11/2023	Deadline 7	LS	CH	TG
P05	S8	05/09/2023	Deadline 4	LS	CH	TG
P04	S8	03/08/2023	Deadline 3	LS	CH	TG
P03	S8	26/05/2023	Rule 6 Letter: Land Registry Update	LS	CH	TG
P02	S1	14/12/2022	Issued for Information	LS	AA	TG
P01	S1	03/10/2022	Issued for Information	LS	AA	TG

1. All dimensions are in metres unless stated otherwise.  
 2. These Special Category Land Plans should be read in conjunction with other plans and documents in the Development Consent Order application (TR020032/APP/3.1), in particular the Book of Reference (TR020032/APP/4.2).  
 3. All easements, servitudes and private rights in land are proposed to be extinguished on land shown coloured pink on these land plans, unless stated otherwise in the Book of Reference.  
 4. All easements, servitudes and private rights in land are proposed to be extinguished, so far as their continued exercise would be inconsistent with the exercise of the rights or restrictions proposed to be acquired by the undertaker on land shown coloured blue on these land plans, unless stated otherwise in the Book of Reference.  
 5. All easements, servitudes and private rights are proposed to be suspended while the undertaker is in temporary possession of the land shown coloured green and blue on these land plans, unless stated otherwise in the Book of Reference.  
 6. The number labels relate to plot numbers. Please refer to the Book of Reference for more information about these plots, including the approximate area of each plot. In this numbering convention, a plot number comprises the sheet number followed by the actual plot number, e.g. Plot 01-24, where '01' is the sheet number.  
 7. Some plots have two leader lines to the same label. These are the same plot connected by a small area that could not be displayed at a suitable scale.

**Legend**

- Order Limits
- Open Space - Temporary Possession of Land and Permanent Acquisition of Rights
- Local Authority Boundary

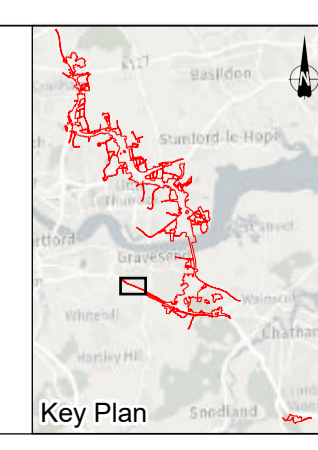

Client  
 national highways  
 Project  
**LOWER THAMES CROSSING**

Status	DCO Application	Original Size	A1	Revision	P07
Application Document Number	TR010032/APP/2.4	Scale	1:2,500		
Drawing Title	<b>SPECIAL CATEGORY LAND PLANS REGULATION 5(2)(i)(iv) SHEET 8</b>				
Drawing Number	HE540039-CJV-BOP-ZZZ_BD000000_-DR-BL-40008				



**NO DESIGN INFORMATION ON THIS SHEET  
FOR SPECIAL CATEGORY LAND PLANS**

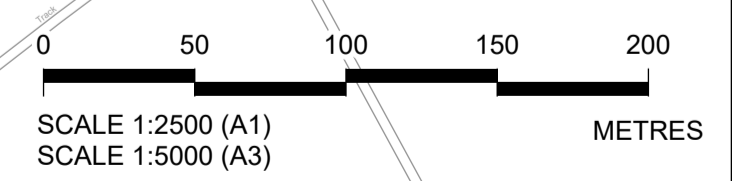
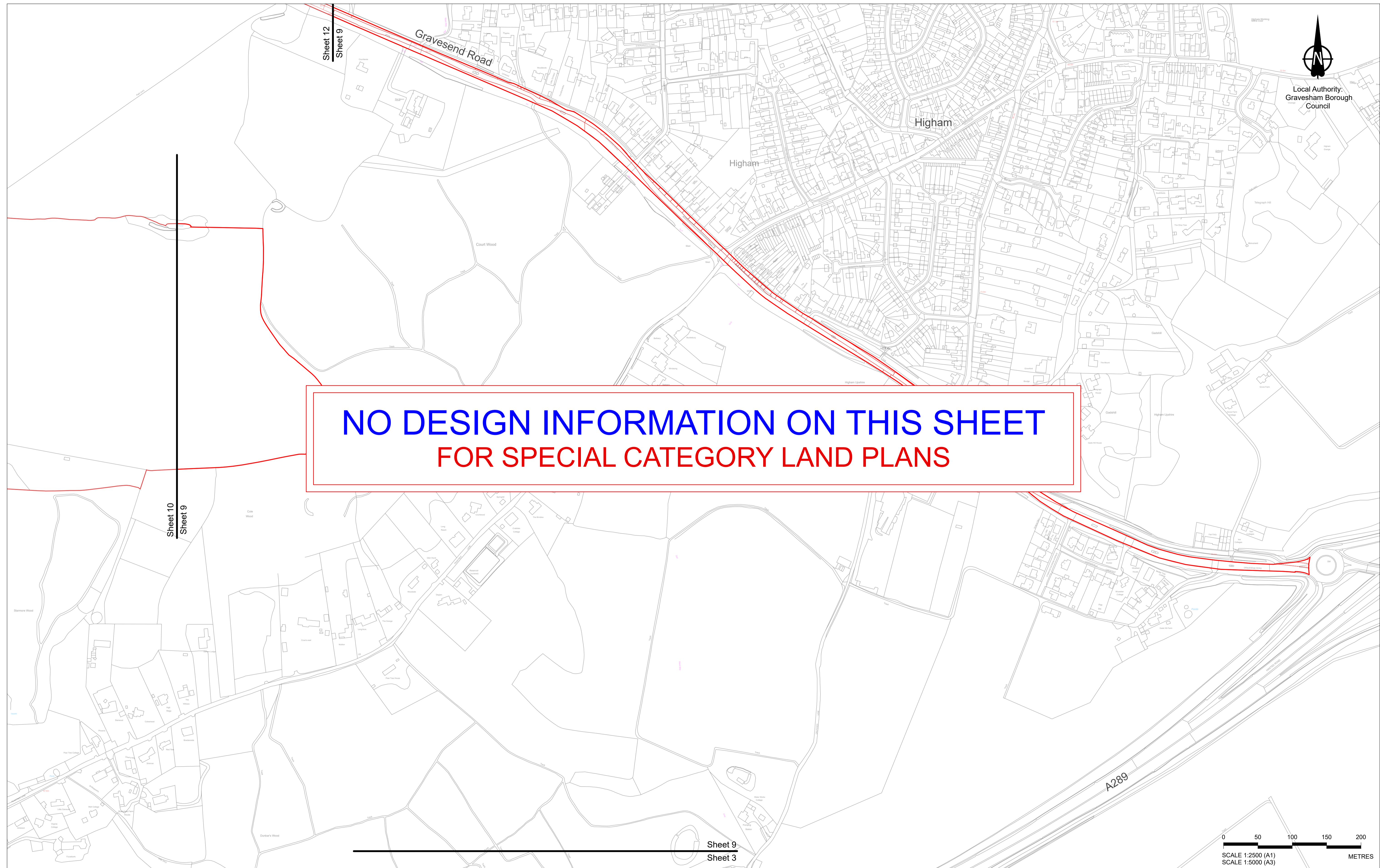

Rev	Status	Rev. Date	Purpose of revision	Drawn	Chck'd	Apprv'd
P07	S8	04/12/2023	Deadline 9	LS	CH	TG
P06	S8	06/11/2023	Deadline 7	LS	CH	TG
P05	S8	05/09/2023	Deadline 4	LS	CH	TG
P04	S8	03/08/2023	Deadline 3	LS	CH	TG
P03	S8	26/05/2023	Rule 6 Letter: Land Registry Update	LS	CH	TG
P02	S1	14/12/2022	Issued for Information	LS	AA	TG
P01	S1	03/10/2022	Issued for Information	LS	AA	TG

1. All dimensions are in metres unless stated otherwise.  
 2. These Special Category Land Plans should be read in conjunction with other plans and documents in the Development Consent Order application (TR020032/APP/3.1), in particular the Book of Reference (TR020032/APP/4.2).  
 3. All easements, servitudes and private rights in land are proposed to be extinguished on land shown coloured pink on these land plans, unless stated otherwise in the Book of Reference.  
 4. All easements, servitudes and private rights in land are proposed to be extinguished, so far as their continued exercise would be inconsistent with the exercise of the rights or restrictions proposed to be acquired by the undertaker on land shown coloured blue on these land plans, unless stated otherwise in the Book of Reference.  
 5. All easements, servitudes and private rights are proposed to be suspended while the undertaker is in temporary possession of the land shown coloured green and blue on these land plans, unless stated otherwise in the Book of Reference.  
 6. The number labels relate to plot numbers. Please refer to the Book of Reference for more information about these plots, including the approximate area of each plot. In this numbering convention, a plot number comprises the sheet number followed by the actual plot number, e.g. Plot 01-24, where '01' is the sheet number.  
 7. Some plots have two leader lines to the same label. These are the same plot connected by a small area that could not be displayed at a suitable scale.

**Legend**  
 Order Limits

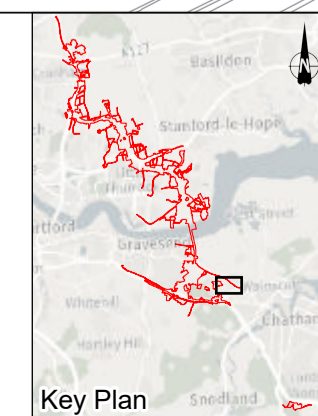

Client  
  
 Project  
**LOWER THAMES CROSSING**

Status	DCO Application	Original Size	A1	Revision	P07
Application Document Number	TR010032/APP/2.4	Scale	1:2,500		
Drawing Title	<b>SPECIAL CATEGORY LAND PLANS REGULATION 5(2)(i)(iv) SHEET 9</b>				
Drawing Number	HE540039-CJV-BOP-ZZZ_BD000000_-DR-BL-40009				



Sheet 12  
Sheet 10

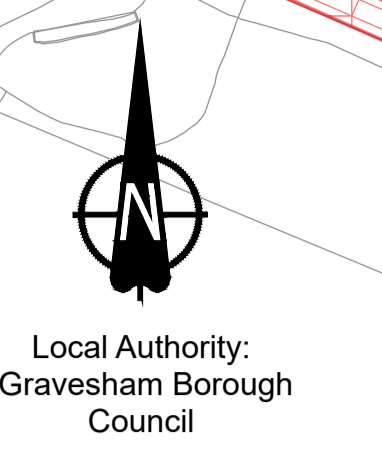

**NO DESIGN INFORMATION ON THIS SHEET  
FOR SPECIAL CATEGORY LAND PLANS**

Sheet 11  
Sheet 10

Sheet 10  
Sheet 4

Sheet 10  
Sheet 9

Sheet 10  
Sheet 3

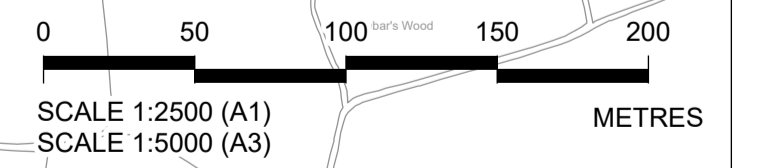

Rev	Status	Rev. Date	Purpose of revision	Drawn	Chck'd	Apprv'd
P07	S8	04/12/2023	Deadline 9	LS	CH	TG
P06	S8	06/11/2023	Deadline 7	LS	CH	TG
P05	S8	05/09/2023	Deadline 4	LS	CH	TG
P04	S8	03/08/2023	Deadline 3	LS	CH	TG
P03	S8	26/05/2023	Rule 6 Letter: Land Registry Update	LS	CH	TG
P02	S1	14/12/2022	Issued for Information	LS	AA	TG
P01	S1	03/10/2022	Issued for Information	LS	AA	TG

1. All dimensions are in metres unless stated otherwise.  
 2. These Special Category Land Plans should be read in conjunction with other plans and documents in the Development Consent Order application (TR020032/APP/3.1), in particular the Book of Reference (TR020032/APP/4.2).  
 3. All easements, servitudes and private rights in land are proposed to be extinguished on land shown coloured pink on these land plans, unless stated otherwise in the Book of Reference.  
 4. All easements, servitudes and private rights in land are proposed to be extinguished, so far as their continued exercise would be inconsistent with the exercise of the rights or restrictions proposed to be acquired by the undertaker on land shown coloured blue on these land plans, unless stated otherwise in the Book of Reference.  
 5. All easements, servitudes and private rights are proposed to be suspended while the undertaker is in temporary possession of the land shown coloured green and blue on these land plans, unless stated otherwise in the Book of Reference.  
 6. The number labels relate to plot numbers. Please refer to the Book of Reference for more information about these plots, including the approximate area of each plot. In this numbering convention, a plot number comprises the sheet number followed by the actual plot number, e.g. Plot 01-24, where '01' is the sheet number.  
 7. Some plots have two leader lines to the same label. These are the same plot connected by a small area that could not be displayed at a suitable scale.

**Legend**  
 Order Limits

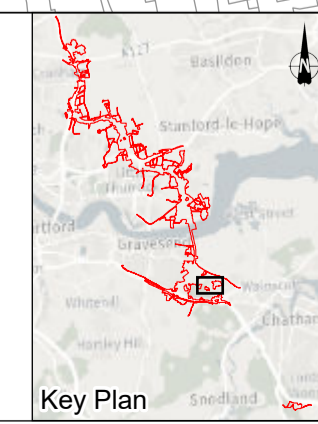

Client  
  
 Project  
**LOWER THAMES CROSSING**

Status	DCO Application	Original Size	A1	Revision	P07
Application Document Number	TR010032/APP/2.4	Scale	1:2,500		
Drawing Title	<b>SPECIAL CATEGORY LAND PLANS REGULATION 5(2)(i)(iv) SHEET 10</b>				
Drawing Number	HE540039-CJV-BOP-ZZZ_BD000000_-DR-BL-40010				





Local Authority:  
Gravesham Borough  
Council

Riverview  
Park

Imperial Drive

Thong Lane

11-79

Southern Valley  
Golf Course

Sheet 11  
Sheet 12



Astra Drive

Inset A

Shorne Woods Country Park  
and  
Shorne Woods SSSI

Sheet 11  
Sheet 6

Thong

Sheet 11  
Sheet 4

Sheet 11  
Sheet 10

Claylane  
Wood

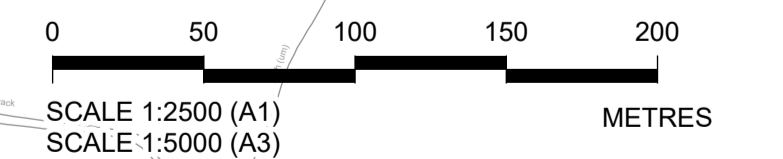

Crown copyright material is reproduced with the permission of Land Registry under delegated authority from the Controller of HMSO. This material was last updated in October 2023 and may not be copied, distributed, sold or published without the formal permission of Land Registry. Contains Ordnance Survey data. © Crown copyright and database rights 2023. OS ACN000827444.

- All dimensions are in metres unless stated otherwise.
- These Special Category Land Plans should be read in conjunction with other plans and documents in the Development Consent Order application (TR020032/APP/3.1), in particular the Book of Reference (TR020032/APP/4.2).
- All easements, servitudes and private rights in land are proposed to be extinguished on land shown coloured pink on these land plans, unless stated otherwise in the Book of Reference.
- All easements, servitudes and private rights in land are proposed to be extinguished, so far as their continued exercise would be inconsistent with the exercise of the rights or restrictions proposed to be acquired by the undertaker on land shown coloured blue on these land plans, unless stated otherwise in the Book of Reference.
- All easements, servitudes and private rights are proposed to be suspended while the undertaker is in temporary possession of the land shown coloured green and blue on these land plans, unless stated otherwise in the Book of Reference.
- The number labels relate to plot numbers. Please refer to the Book of Reference for more information about these plots, including the approximate area of each plot. In this numbering convention, a plot number comprises the sheet number followed by the actual plot number, e.g. Plot 01-24, where '01' is the sheet number.
- Some plots have two leader lines to the same label. These are the same plot connected by a small area that could not be displayed at a suitable scale.

- Legend**
- Order Limits
  - Open Space - Temporary Possession of Land
  - Replacement Land

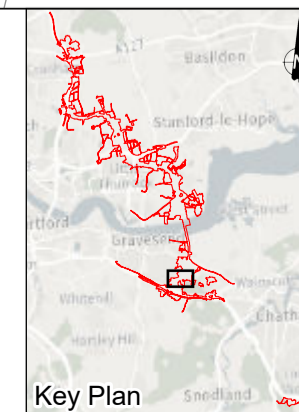

Client



Project

LOWER THAMES CROSSING

Status	DCO Application	Original Size	A1	Revision	P07
Application Document Number	TR010032/APP/2.4	Scale	1:2,500		
Drawing Title	SPECIAL CATEGORY LAND PLANS REGULATION 5(2)(i)(iv) SHEET 11				
Drawing Number	HE540039-CJV-BOP-ZZZ_BD000000_-DR-BL-40011				



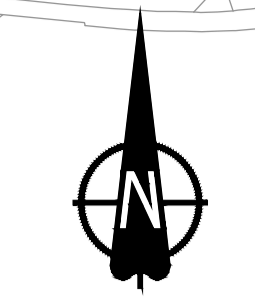

Local Authority:  
Gravesham Borough Council

**NO DESIGN INFORMATION ON THIS SHEET  
FOR SPECIAL CATEGORY LAND PLANS**

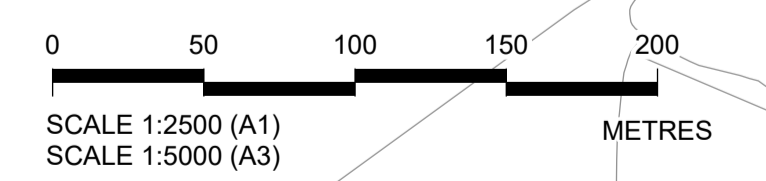
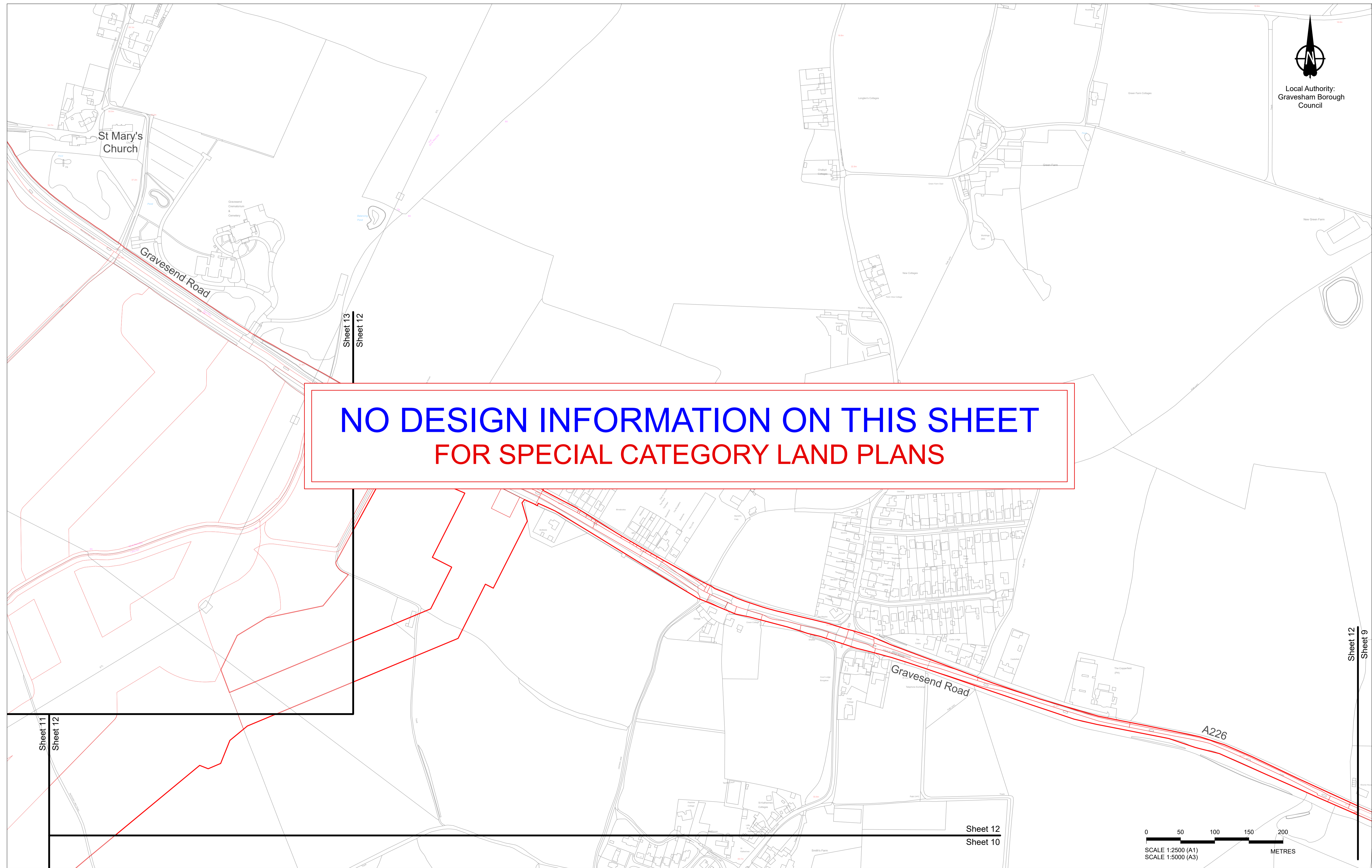

Crown copyright material is reproduced with the permission of Land Registry under delegated authority from the Controller of HMSO. This material was last updated in October 2023 and may not be copied, distributed, sold or published without the formal permission of Land Registry. Contains Ordnance Survey data. © Crown copyright and database rights 2023. OS A201000827444.				
P07	S8	04/12/2023	Deadline 9	LS CH TG
P06	S8	06/11/2023	Deadline 7	LS CH TG
P05	S8	05/09/2023	Deadline 4	LS CH TG
P04	S8	03/08/2023	Deadline 3	LS CH TG
P03	S8	26/05/2023	Rule 6 Letter: Land Registry Update	LS CH TG
P02	S1	14/12/2022	Issued for Information	LS AA TG
P01	S1	03/10/2022	Issued for Information	LS AA TG
Rev	Status	Rev. Date	Purpose of revision	Drawn Chck'd Apprv'd

1. All dimensions are in metres unless stated otherwise.  
 2. These Special Category Land Plans should be read in conjunction with other plans and documents in the Development Consent Order application (TR020032/APP/3.1), in particular the Book of Reference (TR020032/APP/4.2).  
 3. All easements, servitudes and private rights in land are proposed to be extinguished on land shown coloured pink on these land plans, unless stated otherwise in the Book of Reference.  
 4. All easements, servitudes and private rights in land are proposed to be extinguished, so far as their continued exercise would be inconsistent with the exercise of the rights or restrictions proposed to be acquired by the undertaker on land shown coloured blue on these land plans, unless stated otherwise in the Book of Reference.  
 5. All easements, servitudes and private rights are proposed to be suspended while the undertaker is in temporary possession of the land shown coloured green and blue on these land plans, unless stated otherwise in the Book of Reference.  
 6. The number labels relate to plot numbers. Please refer to the Book of Reference for more information about these plots, including the approximate area of each plot. In this numbering convention, a plot number comprises the sheet number followed by the actual plot number, e.g. Plot 01-24, where '01' is the sheet number.  
 7. Some plots have two leader lines to the same label. These are the same plot connected by a small area that could not be displayed at a suitable scale.

Legend  
Order Limits

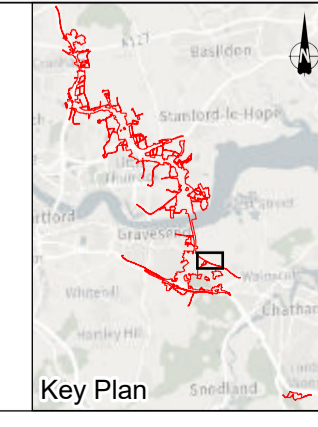

Client  
Project  
LOWER THAMES CROSSING



Status	DCO Application	Original Size	A1	Revision	P07
Application Document Number	TR010032/APP/2.4	Scale	1:2,500		
Drawing Title	SPECIAL CATEGORY LAND PLANS REGULATION 5(2)(i)(iv) SHEET 12				
Drawing Number	HE540039-CJV-BOP-ZZZ_BD000000_-DR-BL-40012				



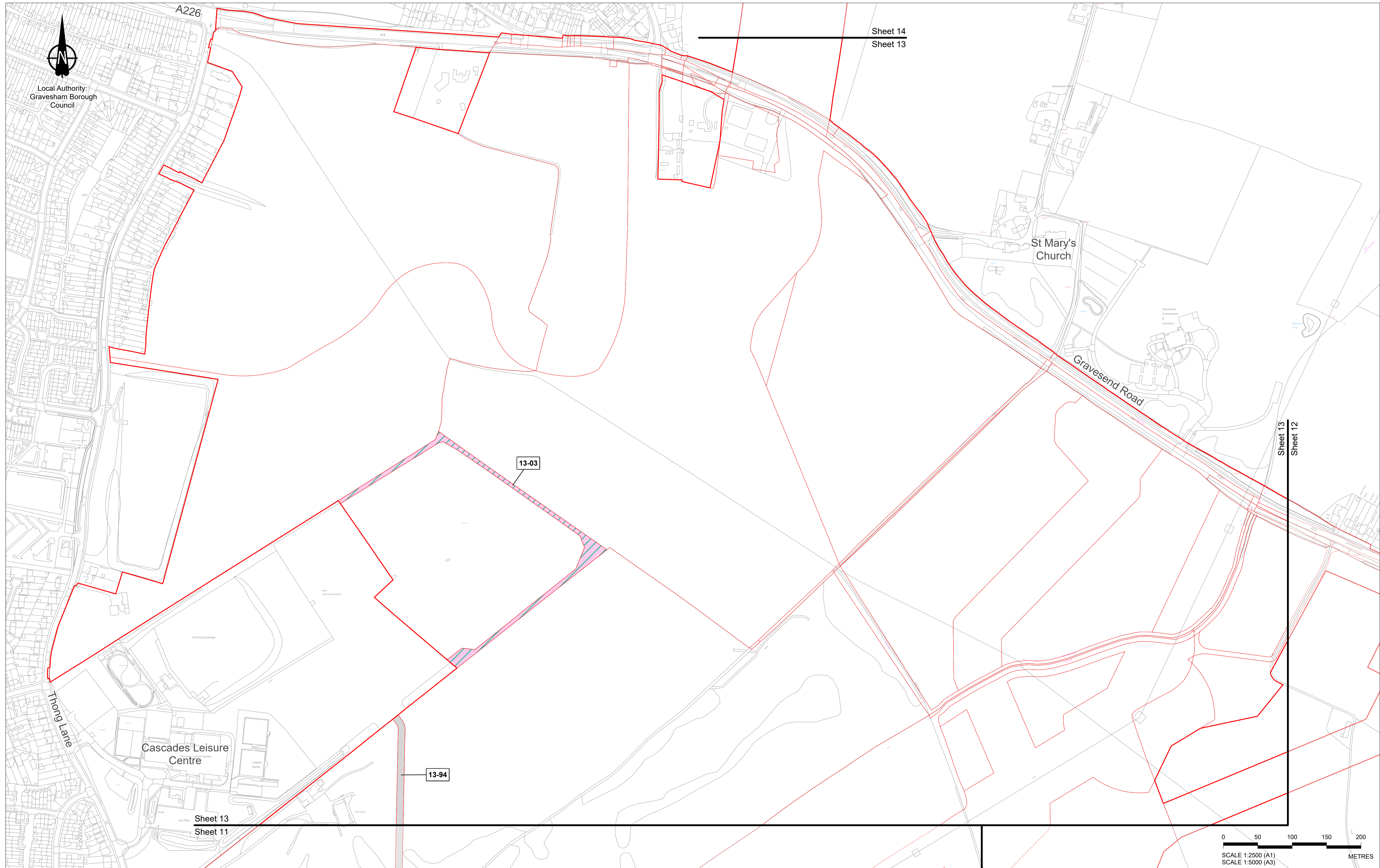

Crown copyright material is reproduced with the permission of Land Registry under delegated authority from the Controller of HMSO. This material was last updated in October 2023 and may not be copied, distributed, sold or published without the formal permission of Land Registry. Contains Ordnance Survey data. © Crown copyright and database rights 2023. OS AC1000027444.

Rev	Status	Rev. Date	Purpose of revision	Drawn	Chck'd	Apprv'd
P07	S8	04/12/2023	Deadline 9	LS	CH	TG
P06	S8	06/11/2023	Deadline 7	LS	CH	TG
P05	S8	05/09/2023	Deadline 4	LS	CH	TG
P04	S8	03/08/2023	Deadline 3	LS	CH	TG
P03	S8	26/05/2023	Rule 6 Letter: Land Registry Update	LS	CH	TG
P02	S1	14/12/2022	Issued for Information	LS	AA	TG
P01	S1	03/10/2022	Issued for Information	LS	AA	TG

1. All dimensions are in metres unless stated otherwise.  
 2. These Special Category Land Plans should be read in conjunction with other plans and documents in the Development Consent Order application (TR020032/APP/3.1), in particular the Book of Reference (TR020032/APP/4.2).  
 3. All easements, servitudes and private rights in land are proposed to be extinguished on land shown coloured pink on these land plans, unless stated otherwise in the Book of Reference.  
 4. All easements, servitudes and private rights in land are proposed to be extinguished, so far as their continued exercise would be inconsistent with the exercise of the rights or restrictions proposed to be acquired by the undertaker on land shown coloured blue on these land plans, unless stated otherwise in the Book of Reference.  
 5. All easements, servitudes and private rights are proposed to be suspended while the undertaker is in temporary possession of the land shown coloured green and blue on these land plans, unless stated otherwise in the Book of Reference.  
 6. The number labels relate to plot numbers. Please refer to the Book of Reference for more information about these plots, including the approximate area of each plot. In this numbering convention, a plot number comprises the sheet number followed by the actual plot number, e.g. Plot 01-24, where '01' is the sheet number.  
 7. Some plots have two leader lines to the same label. These are the same plot connected by a small area that could not be displayed at a suitable scale.

**Legend**

- Order Limits
- Open Space - Permanent Acquisition of Land
- Replacement Land

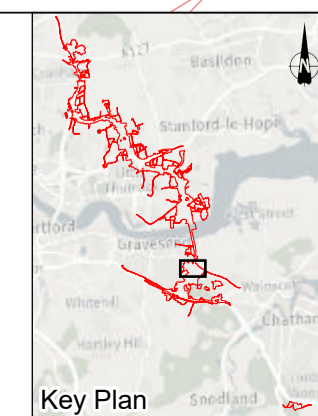

Client  
 Project  
**LOWER THAMES CROSSING**



Status	DCO Application	Original Size	A1	Revision	P07
Application Document Number	TR010032/APP/2.4	Scale	1:2,500		
Drawing Title	<b>SPECIAL CATEGORY LAND PLANS REGULATION 5(2)(i)(iv) SHEET 13</b>				
Drawing Number	HE540039-CJV-BOP-ZZZ_BD000000_-DR-BL-40013				

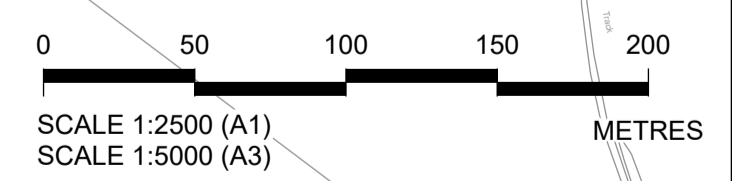





Local Authority:  
Gravesham Borough  
Council

Sheet 15

Sheet 14

North Kent Railway  
Thames and Medway Canal

Filborough Marshes

Thames Estuary and Marshes  
SPA, SSSI and Ramsar Site

**NO DESIGN INFORMATION ON THIS SHEET  
FOR SPECIAL CATEGORY LAND PLANS**

Lower Higham Road

Chalk

A226

Sheet 14

Sheet 13

0 50 100 150 200  
SCALE 1:2500 (A1)  
SCALE 1:5000 (A3) METRES

Crown copyright material is reproduced with the permission of Land Registry under delegated authority from the Controller of HMSO. This material was last updated in October 2023 and may not be copied, distributed, sold or published without the formal permission of Land Registry. Contains Ordnance Survey data. © Crown copyright and database rights 2023. OS ACN000827444.

- All dimensions are in metres unless stated otherwise.
- These Special Category Land Plans should be read in conjunction with other plans and documents in the Development Consent Order application (TR020032/APP/3.1), in particular the Book of Reference (TR020032/APP/4.2).
- All easements, servitudes and private rights in land are proposed to be extinguished on land shown coloured pink on these land plans, unless stated otherwise in the Book of Reference.
- All easements, servitudes and private rights in land are proposed to be extinguished, so far as their continued exercise would be inconsistent with the exercise of the rights or restrictions proposed to be acquired by the undertaker on land shown coloured blue on these land plans, unless stated otherwise in the Book of Reference.
- All easements, servitudes and private rights are proposed to be suspended while the undertaker is in temporary possession of the land shown coloured green and blue on these land plans, unless stated otherwise in the Book of Reference.
- The number labels relate to plot numbers. Please refer to the Book of Reference for more information about these plots, including the approximate area of each plot. In this numbering convention, a plot number comprises the sheet number followed by the actual plot number, e.g. Plot 01-24, where '01' is the sheet number.
- Some plots have two leader lines to the same label. These are the same plot connected by a small area that could not be displayed at a suitable scale.

Legend  
Order Limits

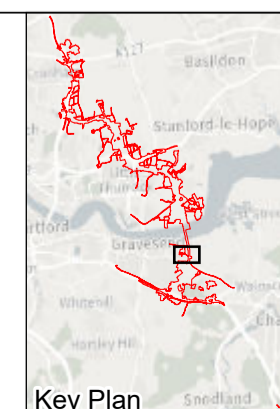

Client



Project

LOWER THAMES CROSSING

Status	DCO Application	Original Size	A1	Revision	P07
Application Document Number	TR010032/APP/2.4	Scale	1:2,500		
Drawing Title	SPECIAL CATEGORY LAND PLANS REGULATION 5(2)(i)(iv) SHEET 14				
Drawing Number	HE540039-CJV-BOP-ZZZ_BD000000_-DR-BL-40014				

Rev	Status	Rev. Date	Purpose of revision	Drawn	Chck'd	Apprv'd
P07	S8	04/12/2023	Deadline 9	LS	CH	TG
P06	S8	06/11/2023	Deadline 7	LS	CH	TG
P05	S8	05/09/2023	Deadline 4	LS	CH	TG
P04	S8	03/08/2023	Deadline 3	LS	CH	TG
P03	S8	26/05/2023	Rule 6 Letter: Land Registry Update	LS	CH	TG
P02	S1	14/12/2022	Issued for Information	LS	AA	TG
P01	S1	03/10/2022	Issued for Information	LS	AA	TG



Thurrock Council  
Gravesham Borough Council

River  
Thames

**NO DESIGN INFORMATION ON THIS SHEET  
FOR SPECIAL CATEGORY LAND PLANS**

North Kent Railway  
Thames and Medway Canal

Sheet 15  
Sheet 14

0 50 100 150 200 METRES  
SCALE 1:2500 (A1)  
SCALE 1:5000 (A3)

Crown copyright material is reproduced with the permission of Land Registry under delegated authority from the Controller of HMSO. This material was last updated in October 2023 and may not be copied, distributed, sold or published without the formal permission of Land Registry. Contains Ordnance Survey data. © Crown copyright and database rights 2023. OS ACN000827444.

Rev	Status	Rev. Date	Purpose of revision	Drawn	Chck'd	Apprv'd
P07	S8	04/12/2023	Deadline 9	LS	CH	TG
P06	S8	06/11/2023	Deadline 7	LS	CH	TG
P05	S8	05/09/2023	Deadline 4	LS	CH	TG
P04	S8	03/08/2023	Deadline 3	LS	CH	TG
P03	S8	26/05/2023	Rule 6 Letter: Land Registry Update	LS	CH	TG
P02	S1	14/12/2022	Issued for Information	LS	AA	TG
P01	S1	03/10/2022	Issued for Information	LS	AA	TG

1. All dimensions are in metres unless stated otherwise.  
2. These Special Category Land Plans should be read in conjunction with other plans and documents in the Development Consent Order application (TR020032/APP/3.1), in particular the Book of Reference (TR020032/APP/4.2).  
3. All easements, servitudes and private rights in land are proposed to be extinguished on land shown coloured pink on these land plans, unless stated otherwise in the Book of Reference.  
4. All easements, servitudes and private rights in land are proposed to be extinguished, so far as their continued exercise would be inconsistent with the exercise of the rights or restrictions proposed to be acquired by the undertaker on land shown coloured blue on these land plans, unless stated otherwise in the Book of Reference.  
5. All easements, servitudes and private rights are proposed to be suspended while the undertaker is in temporary possession of the land shown coloured green and blue on these land plans, unless stated otherwise in the Book of Reference.  
6. The number labels relate to plot numbers. Please refer to the Book of Reference for more information about these plots, including the approximate area of each plot. In this numbering convention, a plot number comprises the sheet number followed by the actual plot number, e.g. Plot 01-24, where '01' is the sheet number.  
7. Some plots have two leader lines to the same label. These are the same plot connected by a small area that could not be displayed at a suitable scale.

**Legend**  
Order Limits  
Local Authority Boundary

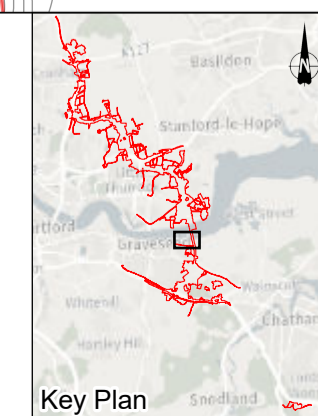

Client  
Project  
**LOWER THAMES CROSSING**



Status	DCO Application	Original Size	A1	Revision	P07
Application Document Number	TR010032/APP/2.4	Scale	1:2,500		
Drawing Title	<b>SPECIAL CATEGORY LAND PLANS REGULATION 5(2)(i)(iv) SHEET 15</b>				
Drawing Number	HE540039-CJV-BOP-ZZZ_BD000000_-DR-BL-40015				



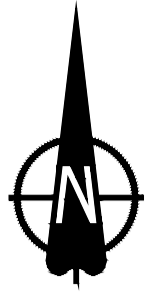

**NO DESIGN INFORMATION ON THIS SHEET  
FOR SPECIAL CATEGORY LAND PLANS**

River  
Thames

Thurrock Council  
Gravesham Borough Council

Sheet 16  
Sheet 15

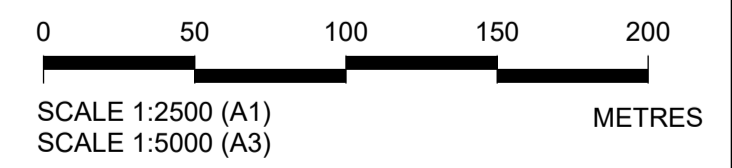

Crown copyright material is reproduced with the permission of Land Registry under delegated authority from the Controller of HMSO. This material was last updated in October 2023 and may not be copied, distributed, sold or published without the formal permission of Land Registry. Contains Ordnance Survey data. © Crown copyright and database rights 2023. OS ACN000827444.						
P07	S8	04/12/2023	Deadline 9	LS	CH	TG
P06	S8	06/11/2023	Deadline 7	LS	CH	TG
P05	S8	05/09/2023	Deadline 4	LS	CH	TG
P04	S8	03/08/2023	Deadline 3	LS	CH	TG
P03	S8	26/05/2023	Rule 6 Letter: Land Registry Update	LS	CH	TG
P02	S1	14/12/2022	Issued for Information	LS	AA	TG
P01	S1	03/10/2022	Issued for Information	LS	AA	TG
Rev	Status	Rev. Date	Purpose of revision	Drawn	Chck'd	Apprv'd

- All dimensions are in metres unless stated otherwise.
- These Special Category Land Plans should be read in conjunction with other plans and documents in the Development Consent Order application (TR020032/APP/3.1), in particular the Book of Reference (TR020032/APP/4.2).
- All easements, servitudes and private rights in land are proposed to be extinguished on land shown coloured pink on these land plans, unless stated otherwise in the Book of Reference.
- All easements, servitudes and private rights in land are proposed to be extinguished, so far as their continued exercise would be inconsistent with the exercise of the rights or restrictions proposed to be acquired by the undertaker on land shown coloured blue on these land plans, unless stated otherwise in the Book of Reference.
- All easements, servitudes and private rights are proposed to be suspended while the undertaker is in temporary possession of the land shown coloured green and blue on these land plans, unless stated otherwise in the Book of Reference.
- The number labels relate to plot numbers. Please refer to the Book of Reference for more information about these plots, including the approximate area of each plot. In this numbering convention, a plot number comprises the sheet number followed by the actual plot number, e.g. Plot 01-24, where '01' is the sheet number.
- Some plots have two leader lines to the same label. These are the same plot connected by a small area that could not be displayed at a suitable scale.

**Legend**  
 Order Limits  
 - - - - Local Authority Boundary

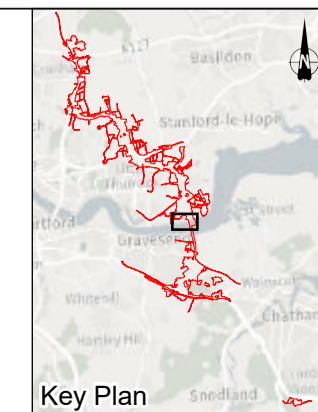

Client: national highways

Project: **LOWER THAMES CROSSING**

Status	DCO Application	Original Size	A1	Revision	P07
Application Document Number	TR010032/APP/2.4	Scale	1:2,500		
Drawing Title	<b>SPECIAL CATEGORY LAND PLANS REGULATION 5(2)(i)(iv) SHEET 16</b>				
Drawing Number	HE540039-CJV-BOP-ZZZ_BD000000_-DR-BL-40016				



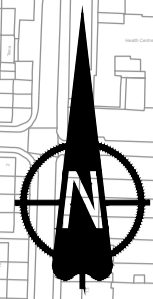

Local Authority:  
Thurrock Council

Sheet 21  
Sheet 17

Sheet 18  
Sheet 17

Sheet 17  
Sheet 16

Thames Sewage  
Treatment Centre

Tilbury  
Fort

River  
Thames

**NO DESIGN INFORMATION ON THIS SHEET  
FOR SPECIAL CATEGORY LAND PLANS**

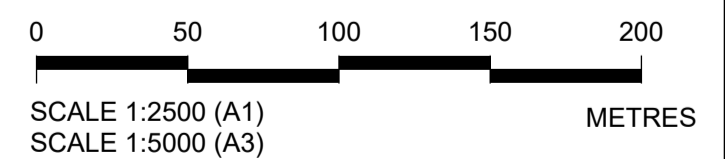

Crown copyright material is reproduced with the permission of Land Registry under delegated authority from the Controller of HMSO. This material was last updated in October 2023 and may not be copied, distributed, sold or published without the formal permission of Land Registry. Contains Ordnance Survey data. © Crown copyright and database rights 2023. OS A20000827444.						
P07	S8	04/12/2023	Deadline 9	LS	CH	TG
P06	S8	06/11/2023	Deadline 7	LS	CH	TG
P05	S8	05/09/2023	Deadline 4	LS	CH	TG
P04	S8	03/08/2023	Deadline 3	LS	CH	TG
P03	S8	26/05/2023	Rule 6 Letter: Land Registry Update	LS	CH	TG
P02	S1	14/12/2022	Issued for Information	LS	AA	TG
P01	S1	03/10/2022	Issued for Information	LS	AA	TG
Rev	Status	Rev. Date	Purpose of revision	Drawn	Chck'd	Apprv'd

- All dimensions are in metres unless stated otherwise.
- These Special Category Land Plans should be read in conjunction with other plans and documents in the Development Consent Order application (TR020032/APP/3.1), in particular the Book of Reference (TR020032/APP/4.2).
- All easements, servitudes and private rights in land are proposed to be extinguished on land shown coloured pink on these land plans, unless stated otherwise in the Book of Reference.
- All easements, servitudes and private rights in land are proposed to be extinguished, so far as their continued exercise would be inconsistent with the exercise of the rights or restrictions proposed to be acquired by the undertaker on land shown coloured blue on these land plans, unless stated otherwise in the Book of Reference.
- All easements, servitudes and private rights are proposed to be suspended while the undertaker is in temporary possession of the land shown coloured green and blue on these land plans, unless stated otherwise in the Book of Reference.
- The number labels relate to plot numbers. Please refer to the Book of Reference for more information about these plots, including the approximate area of each plot. In this numbering convention, a plot number comprises the sheet number followed by the actual plot number, e.g. Plot 01-24, where '01' is the sheet number.
- Some plots have two leader lines to the same label. These are the same plot connected by a small area that could not be displayed at a suitable scale.

Legend  
Order Limits

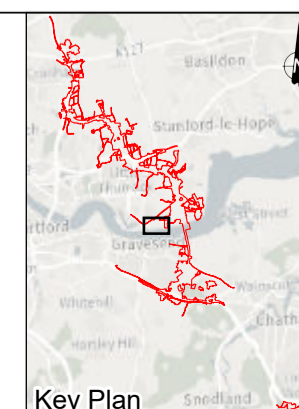

Client  
Project



LOWER THAMES CROSSING

Status	DCO Application	Original Size	Revision
Application Document Number	TR010032/APP/2.4	A1	P07
Drawing Title	SPECIAL CATEGORY LAND PLANS REGULATION 5(2)(i)(iv) SHEET 17		
Drawing Number	HE540039-CJV-BOP-ZZZ_BD000000_-DR-BL-40017		



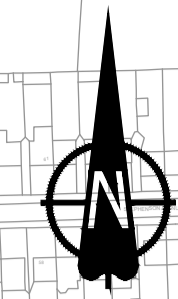

Local Authority:  
Thurrock Council

**NO DESIGN INFORMATION ON THIS SHEET  
FOR SPECIAL CATEGORY LAND PLANS**

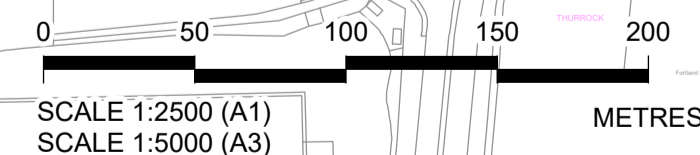

Sheet 18  
Sheet 17

P07	S8	04/12/2023	Deadline 9	LS	CH	TG
P06	S8	06/11/2023	Deadline 7	LS	CH	TG
P05	S8	05/09/2023	Deadline 4	LS	CH	TG
P04	S8	03/08/2023	Deadline 3	LS	CH	TG
P03	S8	26/05/2023	Rule 6 Letter: Land Registry Update	LS	CH	TG
P02	S1	14/12/2022	Issued for Information	LS	AA	TG
P01	S1	03/10/2022	Issued for Information	LS	AA	TG
Rev	Status	Rev. Date	Purpose of revision	Drawn	Chck'd	Apprv'd

1. All dimensions are in metres unless stated otherwise.  
 2. These Special Category Land Plans should be read in conjunction with other plans and documents in the Development Consent Order application (TR020032/APP/3.1), in particular the Book of Reference (TR020032/APP/4.2).  
 3. All easements, servitudes and private rights in land are proposed to be extinguished on land shown coloured pink on these land plans, unless stated otherwise in the Book of Reference.  
 4. All easements, servitudes and private rights in land are proposed to be extinguished, so far as their continued exercise would be inconsistent with the exercise of the rights or restrictions proposed to be acquired by the undertaker on land shown coloured blue on these land plans, unless stated otherwise in the Book of Reference.  
 5. All easements, servitudes and private rights are proposed to be suspended while the undertaker is in temporary possession of the land shown coloured green and blue on these land plans, unless stated otherwise in the Book of Reference.  
 6. The number labels relate to plot numbers. Please refer to the Book of Reference for more information about these plots, including the approximate area of each plot. In this numbering convention, a plot number comprises the sheet number followed by the actual plot number, e.g. Plot 01-24, where '01' is the sheet number.  
 7. Some plots have two leader lines to the same label. These are the same plot connected by a small area that could not be displayed at a suitable scale.

Legend  
Order Limits

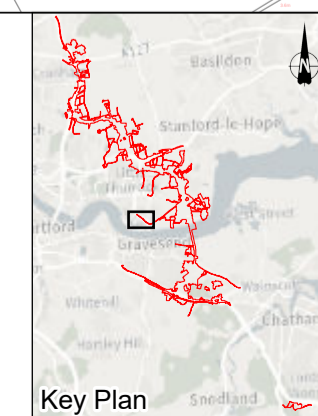

Client  
**national highways**

Project  
**LOWER THAMES CROSSING**

Status	DCO Application	Original Size	A1	Revision	P07
Application Document Number	TR010032/APP/2.4	Scale	1:2,500		
Drawing Title	<b>SPECIAL CATEGORY LAND PLANS REGULATION 5(2)(i)(iv) SHEET 18</b>				
Drawing Number	HE540039-CJV-BOP-ZZZ_BD000000_-DR-BL-40018				



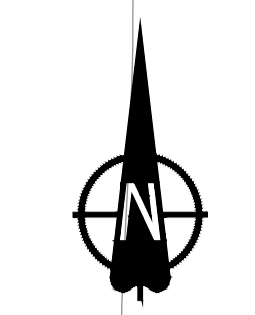
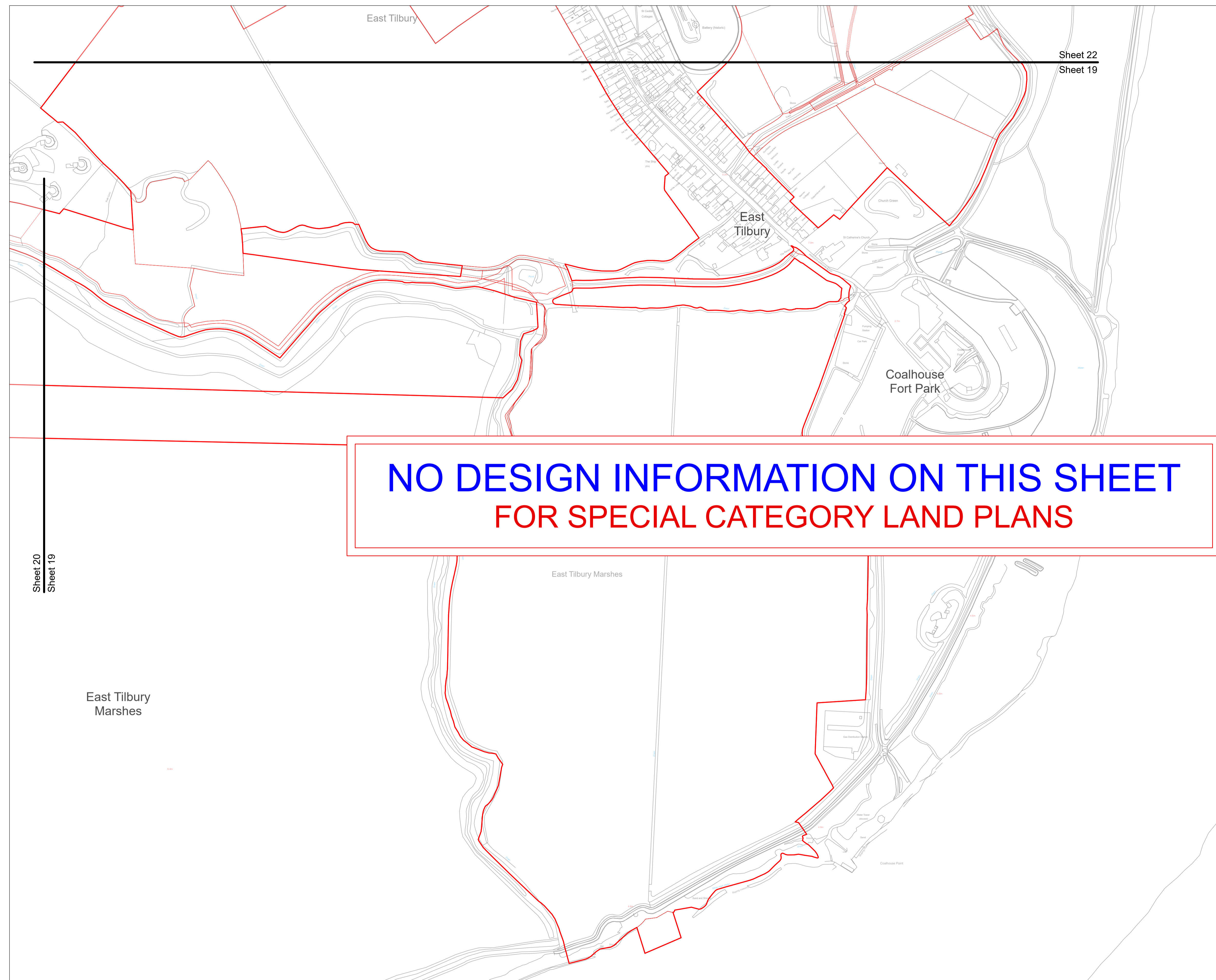

Local Authority:  
Thurrock Council

**NO DESIGN INFORMATION ON THIS SHEET  
FOR SPECIAL CATEGORY LAND PLANS**

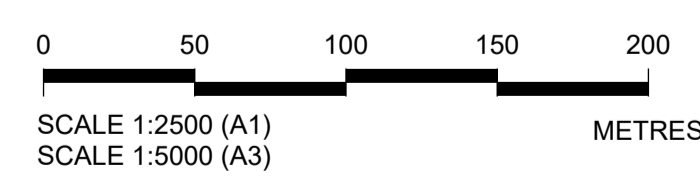

Crown copyright material is reproduced with the permission of Land Registry under delegated authority from the Controller of HMSO. This material was last updated in October 2023 and may not be copied, distributed, sold or published without the formal permission of Land Registry. Contains Ordnance Survey data. © Crown copyright and database rights 2023. OS ACN000827444.

Rev	Status	Rev. Date	Purpose of revision	Drawn	Chck'd	Apprv'd
P07	S8	04/12/2023	Deadline 9	LS	CH	TG
P06	S8	06/11/2023	Deadline 7	LS	CH	TG
P05	S8	05/09/2023	Deadline 4	LS	CH	TG
P04	S8	03/08/2023	Deadline 3	LS	CH	TG
P03	S8	26/05/2023	Rule 6 Letter: Land Registry Update	LS	CH	TG
P02	S1	14/12/2022	Issued for Information	LS	AA	TG
P01	S1	03/10/2022	Issued for Information	LS	AA	TG

1. All dimensions are in metres unless stated otherwise.
2. These Special Category Land Plans should be read in conjunction with other plans and documents in the Development Consent Order application (TR020032/APP/3.1), in particular the Book of Reference (TR020032/APP/4.2).
3. All easements, servitudes and private rights in land are proposed to be extinguished on land shown coloured pink on these land plans, unless stated otherwise in the Book of Reference.
4. All easements, servitudes and private rights in land are proposed to be extinguished, so far as their continued exercise would be inconsistent with the exercise of the rights or restrictions proposed to be acquired by the undertaker on land shown coloured blue on these land plans, unless stated otherwise in the Book of Reference.
5. All easements, servitudes and private rights are proposed to be suspended while the undertaker is in temporary possession of the land shown coloured green and blue on these land plans, unless stated otherwise in the Book of Reference.
6. The number labels relate to plot numbers. Please refer to the Book of Reference for more information about these plots, including the approximate area of each plot. In this numbering convention, a plot number comprises the sheet number followed by the actual plot number, e.g. Plot 01-24, where '01' is the sheet number.
7. Some plots have two leader lines to the same label. These are the same plot connected by a small area that could not be displayed at a suitable scale.

**Legend**  
 Order Limits  
 - - - - Local Authority Boundary

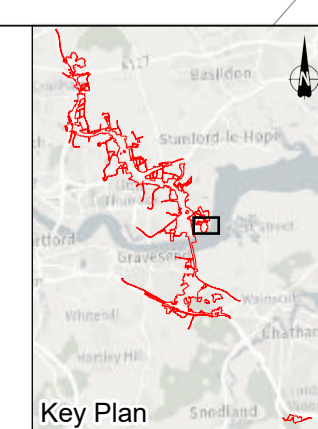

Client  
  
 Project  
**LOWER THAMES CROSSING**

Status	DCO Application	Original Size	A1	Revision	P07
Application Document Number	TR010032/APP/2.4	Scale	1:2,500		
Drawing Title	<b>SPECIAL CATEGORY LAND PLANS REGULATION 5(2)(i)(iv) SHEET 19</b>				
Drawing Number	HE540039-CJV-BOP-ZZZ_BD000000_-DR-BL-40019				



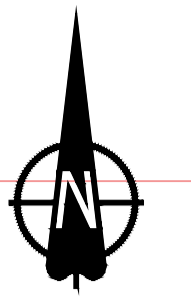
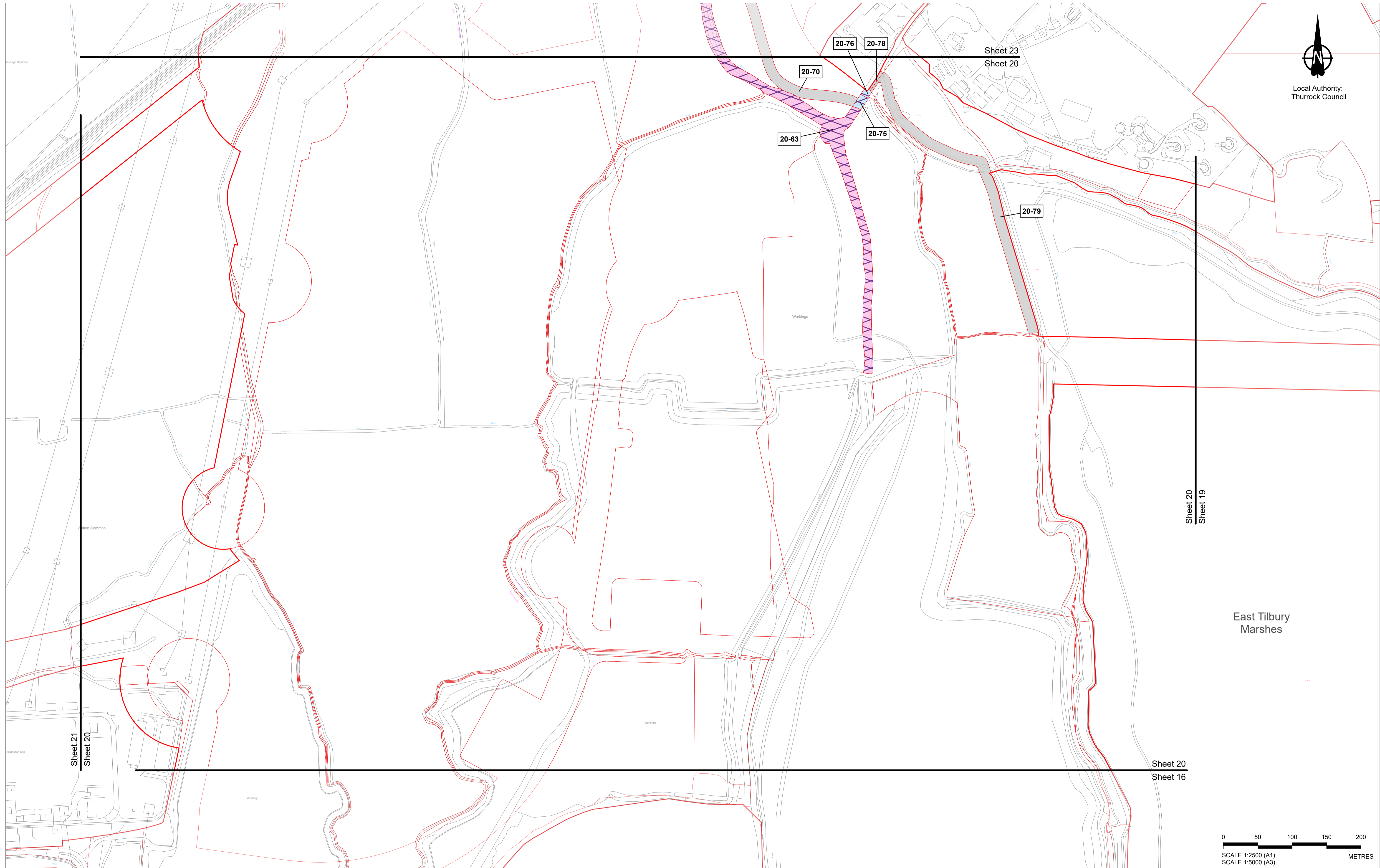

Local Authority:  
Thurrock Council

East Tilbury Marshes

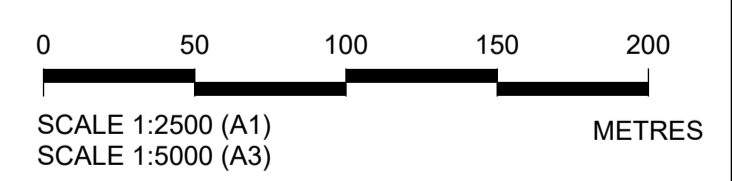

Rev	Status	Rev. Date	Purpose of revision	Drawn	Chck'd	Apprv'd
P07	S8	04/12/2023	Deadline 9	LS	CH	TG
P06	S8	06/11/2023	Deadline 7	LS	CH	TG
P05	S8	05/09/2023	Deadline 4	LS	CH	TG
P04	S8	03/08/2023	Deadline 3	LS	CH	TG
P03	S8	26/05/2023	Rule 6 Letter: Land Registry Update	LS	CH	TG
P02	S1	14/12/2022	Issued for Information	LS	AA	TG
P01	S1	03/10/2022	Issued for Information	LS	AA	TG

1. All dimensions are in metres unless stated otherwise.  
 2. These Special Category Land Plans should be read in conjunction with other plans and documents in the Development Consent Order application (TR020032/APP/3.1), in particular the Book of Reference (TR020032/APP/4.2).  
 3. All easements, servitudes and private rights in land are proposed to be extinguished on land shown coloured pink on these land plans, unless stated otherwise in the Book of Reference.  
 4. All easements, servitudes and private rights in land are proposed to be extinguished, so far as their continued exercise would be inconsistent with the exercise of the rights or restrictions proposed to be acquired by the undertaker on land shown coloured blue on these land plans, unless stated otherwise in the Book of Reference.  
 5. All easements, servitudes and private rights are proposed to be suspended while the undertaker is in temporary possession of the land shown coloured green and blue on these land plans, unless stated otherwise in the Book of Reference.  
 6. The number labels relate to plot numbers. Please refer to the Book of Reference for more information about these plots, including the approximate area of each plot. In this numbering convention, a plot number comprises the sheet number followed by the actual plot number, e.g. Plot 01-24, where '01' is the sheet number.  
 7. Some plots have two leader lines to the same label. These are the same plot connected by a small area that could not be displayed at a suitable scale.

Legend	
	Order Limits
	Common Land - Permanent Acquisition of Land
	Common Land - Temporary Possession of Land and Permanent Acquisition of Rights
	Replacement Land

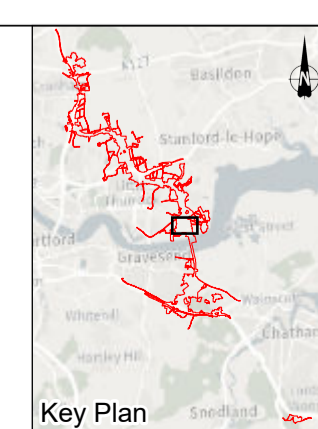

Client:

Project: LOWER THAMES CROSSING

Status	DCO Application	Original Size	A1	Revision	P07
Application Document Number	TR010032/APP/2.4	Scale	1:2,500		
Drawing Title	SPECIAL CATEGORY LAND PLANS REGULATION 5(2)(i)(iv) SHEET 20				
Drawing Number	HE540039-CJV-BOP-ZZZ_BD000000_-DR-BL-40020				



If you need help accessing this or any other National Highways information, please call **0300 123 5000** and we will help you.

© Crown copyright 2023.

You may re-use this information (not including logos) free of charge in any format or medium, under the terms of the Open Government Licence. To view this licence:

visit [www.nationalarchives.gov.uk/doc/open-government-licence/](http://www.nationalarchives.gov.uk/doc/open-government-licence/)

write to the **Information Policy Team, The National Archives, Kew, London TW9 4DU**, or email [psi@nationalarchives.gsi.gov.uk](mailto:psi@nationalarchives.gsi.gov.uk).

Mapping (where present): © Crown copyright and database rights 2023 OS [www.os.gov.uk](http://www.os.gov.uk). You are permitted to use this data solely to enable you to respond to, or interact with, the organisation that provided you with the data. You are not permitted to copy, sub-licence, distribute or sell any of this data to third parties in any form.

If you have any enquiries about this publication email [info@nationalhighways.co.uk](mailto:info@nationalhighways.co.uk) or call **0300 123 5000**.\*

\*Calls to 03 numbers cost no more than a national rate call to an 01 or 02 number and must count towards any inclusive minutes in the same way as 01 and 02 calls.

These rules apply to calls from any type of line including mobile, BT, other fixed line or payphone. Calls may be recorded or monitored.

Printed on paper from well-managed forests and other controlled sources when issued directly by National Highways.

Registered office Bridge House, 1 Walnut Tree Close, Guildford GU1 4LZ

National Highways Limited registered in England and Wales number 09346363